

**MISCELLANEOUS ITEMS**

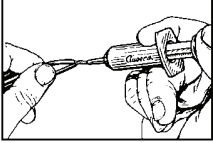

1) Apply Solder Paste

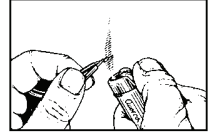

2) Apply heat until paste begins to bubble

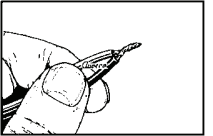

3) Solder will solidify

**Solder Paste**

**Works With The Head Of A Match, Lighter, Soldering Iron Or Torch.**

Five times stronger than ordinary Solder. Provides strength without the distortion of high temperature brazing.



**20409**

Silver Bearing Solder Paste

For Ferrous and Non-Ferrous Metals: steel, cast iron, stainless steel, brass, bronze, nickel, platinum, chrome, monel, galvanized, gold & silver. Auto electrical systems, circuit boards, etc. Flows freely at 430° F. Tensile Strength: 10,000 to 25,000 PSI. 7.1 grams syringe

UNIT PACKAGE: 1

**20410**

Copper Bearing Lead-Free Solder Paste

For use with copper. Also works on brass, stainless steel, nickel and bronze. Does not contain any lead, cadmium or antimony. Flows freely at 430° F. Tensile strength: 10,000 to 25,000 PSI. 14.7 grams syringe

UNIT PACKAGE: 1



**Weld Pins**

Round Head • Copper Plated Steel

By welding these pins to a damaged body panel, a body shop technician can use a gripping tool to pull the dent out of the panel.

Pin Diameter: 2mm (.080")  
Length: 2"  
Head Diameter: .145"

**19095** UNIT PACKAGE: 100  
**19096** UNIT PACKAGE: 250  
**19097** UNIT PACKAGE: 500

Pin Diameter: 2.5mm (.098")  
Length: 2"  
Head Diameter: .175"

**19098** UNIT PACKAGE: 100  
**19099** UNIT PACKAGE: 250  
**19100** UNIT PACKAGE: 500



**WELDING BLANKET**

**Part No. 21083**

A 6 ft. x 6 ft. lightweight, soft and flexible welding blanket for draping over equipment or floor surfaces in welding areas, or as a vertical shield to protect from the spray of sparks, spatter and slag. Our fire and heat resistant welding blankets are made with a carbon fiber fabric that was developed from NASA technologies. The carbon fibers can withstand temperatures of 1800° F from contact with hot metal, weld spatter or the welding flame for short durations but should not be exposed to temperatures of 200° F for extended periods as the carbon fibers will break down. The blankets are easy to clean; just shake, vacuum or use compressed air to blow metal particles out.

UNIT PACKAGE: 1

**MOULDING TAPE**

For Mounting Exterior Trim, Side Mouldings, Emblems & Nameplates



- \*Acrylic foam tape with an aggressive, high performance adhesive on both sides.
- \*Works on all types of plastic mouldings & emblems
- \*Will not crack or dry out
- \*Will not absorb water
- \*Will not migrate in hot weather

**21074**

.045" thick x 3/16" wide x 60 ft.

UNIT PACKAGE: 1 Roll

**21075**

.045" thick x 1/2" wide x 60 ft.

UNIT PACKAGE: 1 Roll

**21076**

.045" thick x 7/8" wide x 60 ft.

UNIT PACKAGE: 1 Roll

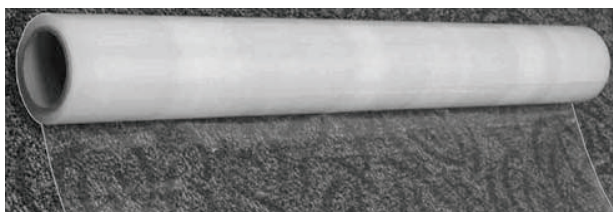

**WEATHER-SEAL WRAP**

Our Weather-Seal Wrap is a clear, plastic film that has an adhesive on one side that is strong enough to hold the wrap in place on almost any surface and seal out contaminants, yet it can be easily removed without pulling off paint, leaving adhesive residue or damaging the surface. With it you can seal out rain, snow, wind and dirt when windshields or door glass has been broken. In addition, Weather-Seal Wrap can be used to protect vehicle carpet and upholstery from soiling and spills. Apply it to paint booth walls and prevent over spray from discoloring white walls. Weather-Seal Wrap has 3 mils of plastic protection to preserve finishes that it covers so it can also be used as a temporary, protective coating against light abrasions.

**21077**

24" wide x 200 ft. long

UNIT PACKAGE: 1 Roll

**21078**

36" wide x 200 ft. long

UNIT PACKAGE: 1 Roll

**Plastic Renew® Automotive Plastic & Rubber Restoring Kit**

**20699**



Plastic Renew is a complete plastic and rubber restoring kit. Fading and discoloring are removed by using the steel wool supplied in the kit. Plastic Renew is applied with the applicator towel. Two to three coats of Plastic Renew brings out a brilliant shine that will last for years. This product will not come off with normal washing. One kit completely shines the interior (trim, dash, consoles & door panels) and exterior (mirrors, bumpers & running boards) of most full-sized vehicles.

**Not for use on tires.**

UNIT PACKAGE: 1 Kit

**MISCELLANEOUS ITEMS**

**Plastic And Headlight Resurfacer/Protector**

**20791**



**Don't compromise when it comes to safety.** Yellowed or cloudy headlights impair night vision. Use of this product on yellowed or discolored headlights will significantly increase the clarity of the lens giving the driver the ability to see better at night. 3 easy steps and about 15 minutes is all it takes to restore most headlights to a like-new appearance that lasts. In addition, it may be used safely on most types of plastics, windshields and more.

Kit Includes: Complete instructions, Pretreatment, Water Base Pretreatment, Oxidation Remover, Shine Restorer/Protector (Increases shine, seals & protects), gloves, sanding sheets, and lint free paper towels.

UNIT PACKAGE: 1 Kit

**Trunk/Vibration/Sound Dampening Pads**

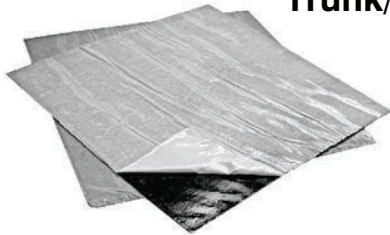

**16506**

12" x 12" x .060" thick pads with adhesive backs. Can be cut to shape and painted for easy installation. The clear vinyl sheet on the black side must be removed before painting. Meets GM specification #2747M.

UNIT PACKAGE: 6

**Vinyl Gloves**

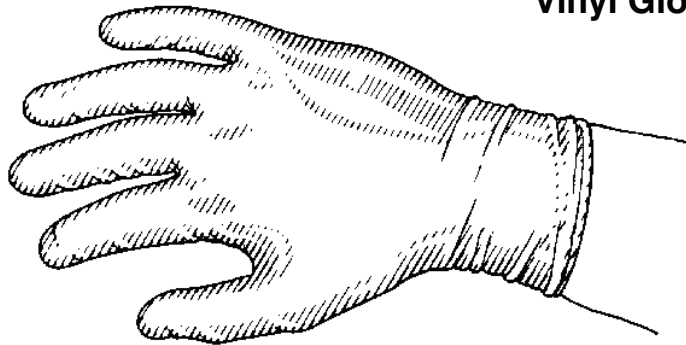

**19551**

- Large Size
- Form Fitting Fits Right or Left Hand
- Lightly Dusted With Corn Starch
- Non-Sterile
- Not For Immersion In Chemicals

UNIT PACKAGE: 100 Gloves (50 pairs)

**BLUE NITRILE GLOVES  
CHEMICAL RESISTANT**



- \*4 MIL Non-Latex
- \*Puncture Resistant
- \*Fits right or left hand

- \*Secure Grip - Wet or Dry
- \*Powder Free
- \*Hypoallergenic

Nitrile is resistant to chemicals commonly found in auto, auto body and glass shops including solvents, parts cleaners, paint thinners, lacquers, urethane, enamel, epoxy resins and sealants

- 20689** Size: Medium Unit Package: 100 Gloves (50 pairs)
- 20690** Size: Large Unit Package: 100 Gloves (50 pairs)
- 20691** Size: Extra Large Unit Package: 100 Gloves (50 pairs)



## PAINTER'S GLOVES

Extra Long

- \*Heavy Duty Applications
- \*Textured Fingers & Palm
- \*Flock Lined For Added Comfort

**20692** Size: Large  
**20693** Size: Extra Large

- \*Superior Protection Of Nitrile
- \*Secure Grip - Wet or Dry
- \*Strong - Durable - Reusable

Unit Package: 1 Pair  
 Unit Package: 1 Pair

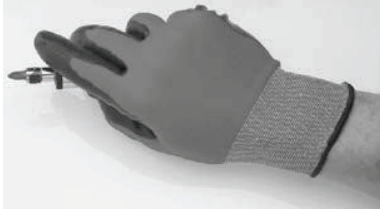

## STRONGHOLD GLOVES

Micro-Knit With Nitrile Palms

- \*Superior Dexterity & Durability
- \*"Breathable" Micro-Knit
- \*Machine Washable

**20694** Size: Large  
**20695** Size: Extra Large

- \*Excellent Gripping Power
- \*Super Lightweight
- \*Seamless Comfort

Unit Package: 1 Pair  
 Unit Package: 1 Pair



## Rough Service Long Life Light Bulbs

The Rough Service bulb features a special filament that withstands shock and vibration. It was designed exclusively for the automotive service industry. The brass base eliminates "freezing" or corroding in the socket; however, it will explode if it comes in contact with a liquid.

**16570**  
 Rough Service  
 75 Watt  
 UNIT PKG: 6

**16571**  
 Rough Service  
 75 Watt  
 UNIT PKG: 120  
 (1 Case of  
 20 Six-Paks)



## Super Toughcoat Long Life Light Bulbs

Super Toughcoat's amazing silicon coating makes it the safest, sturdiest light bulb ever developed. Patented coating protects personnel and products from shattered glass caused by impact, dropping, unusual stress, contact with liquids and thermal shock. Brass base eliminates "freezing" or corroding in the socket.

**16574**  
 Super Toughcoat  
 75 Watt  
 UNIT PKG: 6

**16575**  
 Super Toughcoat  
 100 Watt  
 UNIT PKG: 6

# Sec. 27

# MISCELLANEOUS ITEMS

## Acid Brushes



Tin Handle Horse Hair Bristles

Auveco Part No.	Width	Trim	Length	Unit Pkg.
15793	1/4"	3/4"	6"	1 Gross
15794	3/8"	3/4"	6"	1 Gross
15795	1/2"	13/16"	6"	1 Gross
15796	9/16"	7/8"	6"	1 Gross
15798	3/4"	1"	6-3/8"	1 Gross

## Chip Brushes



Wood Handle Natural Bristles

Auveco Part No	Width	Trim	Unit Pkg.
15800	1-1/2"	1-5/8" x 5/16"	5
15801	2"	1-1/2" x 5/16"	4

## Chip & Dope Brush Wood Handle Horse Hair Bristles



Auveco Part No.	Width	Trim	Length	Unit Pkg.
15799	11/16"	1-1/8"	7"	25

## Steel Wire Scratch Brushes Wood Handle



Type 1



Type 2

Auveco Part No.	Type	Size of Block	Rows	Trim	Wire	Unit Pkg.
15803	1	14" x 1"	3 x 19	1-3/16"	33 Gauge Steel	1
15805	2	10" x 1-1/8"	4 x 16	1-3/16"	33 Gauge Steel	1

## Bin Labels

(Refer To Page 284 For Additional Information)

2" x 3/4" Pressure Sensitive Bin Labels Covering Popular Size U.S.S., S.A.E. And Metric Fasteners.  
36 Labels Per Each 6-1/4" x 9" Page.

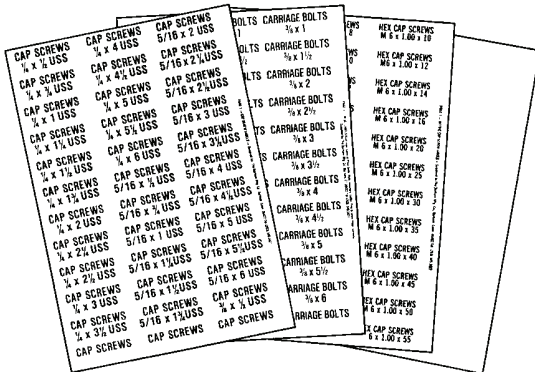

- 15531 U.S.S. Fasteners -6 Pages
  - 15532 S.A.E. Fasteners -6 Pages
  - 14773 Miscellaneous Fasteners -6 Pages
  - 14774 Metric Fasteners -9 Pages
  - 14775 Blank Labels -5 pages
  - 15533 Bin Label Assortment
- 1 Each Of 15531, 15532, 14773, 14774, & 14775

All Packed 1 Set



# MISCELLANEOUS ITEMS

**Sec. 27**



## Toggle Bolts Spring Wing Type

Auveco Part No.	Head Style	Screw Dia.	Thread Size	Use Drill	Unit Pkg
10011	Mushroom	1/8"	6-32 x 3"	3/8"	10
10012	Mushroom	1/8"	6-32 x 4"	3/8"	10
10013	Round Slotted	3/16"	10-24 x 3"	9/16"	10
10014	Round Slotted	3/16"	10-24 x 4"	9/16"	10
10018	Round Slotted	1/4"	1/4-20 x 4"	3/4"	10

## Plastic Screw Anchors



Auveco Part No.	Screw Size	Hole Size	Length	Color	Unit Pkg
9986	3/8"	7/16"	3"	Gray	10



## Hammer Drive Anchors All Steel

Auveco Part No.	Size	Unit Hole Size	Pkg
12858	1/4" x 3/4"	1/4"	25
12859	1/4" x 1"	1/4"	25
12860	1/4" x 1-1/4"	1/4"	10
12861	1/4" x 1-1/2"	1/4"	10
12862	1/4" x 2"	1/4"	10

## Nylon Anchor Steel Nail



Auveco Part No.	Size	Unit Head Style	Pkg
12870	1/4" x 1"	Mushroom	25



## Hex Nut Masonry Anchor

Auveco Part No.	Hole Size	Effective Anchor Length	Fastens Material Up to	Unit Pkg
12875	3/8"	3"	1-3/4"	10



## Hollow Wall Anchor Drive Type

Auveco Part No.	Size	Wall Thickness	Drill Size	Unit Pkg
12890	1/8" Long	5/8" to 7/8"	1/4"	10



## Plastic Anchors

Auveco Part No.	Screw Size	Drill Size	Unit Pkg
10005	#4-#8	3/16"	50
12851	#6-#10	3/16"	50
10006	#10-#12	1/4"	50
12852	1/4"-5/16"	5/16"	50



## Machine Screw Anchor Rust Proof Type

Auveco Part No.	Screw Size	Drill Size	Unit Pkg
9999	1/4"-20	1/2"	25

Note: One Setting Tool Included w/Each Box.

## Lag Screw Shields

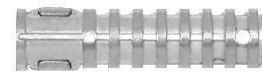

Auveco Part No.	Screw Size	Length	Drill Size	Unit Pkg
9992	1/4"	Long	1/2"	10
9994	3/8"	Long	5/8"	10



## Hollow Wall Anchors

Auveco Part No.	Size	Wall or Surface Thickness	Unit Pkg
10008	1/8" Long	5/8" to 1-1/4"	10
10009	3/16" Short	1/8" to 5/8"	10
10010	3/16" Long	5/8" to 1-1/4"	10
12831	1/4" Short	1/8" to 5/8"	10
12832	1/4" Long	5/8" to 1-1/4"	10

**Sec. 27**

**MISCELLANEOUS ITEMS**



**Hollow Wall Toggle  
With Screws**

Auveco Part No.	Toggle Size	Screw Length	Hole Size	Unit Pkg.
<b>12833</b>	1/8"	2"	3/8"	10



**Screw Pin  
Anchor Shackles**

Galvanized Weldless Drop Forged Stud With Alloy Pin.

Auveco Part No.	Size	Length Inside	Dimensions Between Eyes	Diam Pin	Safe Working Load (Tons)	Unit Pkg.
<b>12184</b>	5/16"	1-1/4"	9/16"	3/8"	3/4"	1
<b>12187</b>	1/2"	.2"	7/8"	5/8"	.2"	1



**Wire Rope Thimble  
Galvanized**

Auveco Part No.	For Diam. Rope	Outside Width Across Score	Width Inside	Length Overall	Unit Pkg.
<b>12192</b>	1/8"	9/32"	23/32"	1-3/4"	10



**"Nipper" Wire Rope Clip**

Galvanized Malleable Iron Base  
Zinc Plated Stud U-bolt

Auveco Part No.	For Diam. Rope	Diam.	U-Bolt Dimensions Length Overall	Center to Center	Unit Pkg.
<b>12171</b>	1/8"	3/16"	1"	1/2"	6
<b>12172</b>	3/16"	1/4"	1-1/16"	9/16"	6
<b>12173</b>	1/4"	5/16"	1-1/2"	11/16"	6
<b>12175</b>	3/8"	3/8"	2"	7/8"	4
<b>12177</b>	1/2"	7/16"	2-3/8"	1"	4



**Bolt Snap**

Malleable Iron • Cadmium Plated

Auveco Part No.	Type	Size of Eye	Overall Length	Ring Size Snap Opening	Unit Pkg.
<b>12169</b>	2	5/8"	4"	3/8"	2

# MISCELLANEOUS ITEMS

## Nylon Spacer Bushings (Stand-Offs)



Tough and resilient white nylon spacer bushings are ideal for use in electrical and electronic applications or anywhere a slip surface is needed. They can be used as bushings, bearings, rollers, glides or separators.

Auveco Part No.	I.D.	O.D.	Length	Unit Pkg.
<b>16198</b>	.257"	1/2"	1/4"	100
<b>16200</b>	.257"	1/2"	3/8"	100
<b>16202</b>	.257"	1/2"	1/2"	100
<b>16204</b>	.257"	1/2"	5/8"	100
<b>16205</b>	.257"	1/2"	3/4"	100
<b>16207</b>	.257"	1/2"	1"	100

## Standard Insulating Bushings

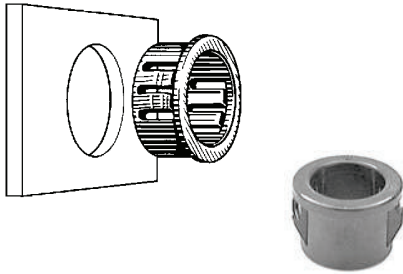

Nylon bushings designed to protect wires, cables, tubing, etc. from sharp, unfinished panel edges. Each size bushing employs multiple lock features to positively snap into panels ranging from 1/32" to 1/8" thickness. Available in both black and white nylon.

Auveco Part No.		Dimensions			Panel Hole Dia.	Unit Pkg.
Black Nylon	White Nylon	Inside Dia.	Head Dia.	Thick-ness		
<b>16087</b>	· · ·	1/4"	15/32"	13/32"	3/8"	50
<b>16088</b>	· · ·	3/8"	37/64"	13/32"	1/2"	50
<b>16089</b>	· · ·	7/16"	21/32"	13/32"	9/16"	50
<b>16090</b>	· · ·	1/2"	23/32"	13/32"	5/8"	50
<b>16091</b>	· · ·	5/8"	27/32"	13/32"	3/4"	50
<b>16092</b>	· · ·	11/16"	61/64"	29/64"	7/8"	50
<b>16093</b>	· · ·	3/4"	1-1/8"	29/64"	1"	50
<b>16094</b>	· · ·	15/16"	1-7/32"	29/64"	1-3/32"	50
<b>16095</b>	<b>16107</b>	15/16"	1-23/64"	29/64"	1-1/4"	50
<b>16096</b>	<b>16108</b>	1-5/16"	1-39/64"	29/64"	1-1/2"	25
<b>16097</b>	· · ·	1-5/8"	2-1/8"	29/64"	2"	25

## All-Fit Adjustable Bushings



Black nylon "ALL-FIT" Adjustable Bushings are designed to protect wire, cable, tubing or irregular shaped items from sharp, unfinished edges. The specially designed resilient multiple supports absorb shock and vibration, and adjust to accept various diameters and shapes. The ALL-FIT Bushing is equipped with multiple locks to positively snap in panel thicknesses ranging from 1/32" to 1/8"

Auveco Part No.	Panel Hole Dia.	Bushings Dimensions			Unit Pkg.
		Head Dia.	Thick-ness	Max. I.D.	
<b>16564</b>	5/8"	23/32"	13/32"	7/16"	50
<b>16565</b>	3/4"	55/64"	25/64"	1/2"	50
<b>16567</b>	7/8"	15/16"	29/64"	9/16"	50
<b>16568</b>	1"	1-1/16"	29/64"	3/4"	50





**Pushnut Fasteners  
(Axle Caps)**

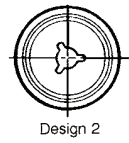
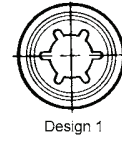
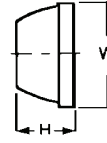
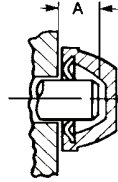

- Cover Color - Black  
Cover Material - Plastic
- Caps self-align on shafts
  - Low push-on force, high retention
  - Fast installation

Auveco Part No.	Unit Pkg.	Shaft Dia.	Cap O.D. W	Height Overall H	Min. shaft Extension A	Steel Thickness	Tooth Design	Min. Push-on Force	Min. Holding Strength
<b>14178</b>	50	3/16"	.656	.344	.150	.012	2	35	220
<b>16605</b>	15	3/4"	1.300	.645	.200	.018	1	95	1200

**Washer Cap Type Pushnut Fasteners**

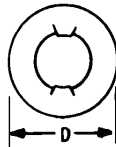
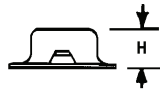

Finish - Zinc

Auveco Part No.	Unit Pkg.	Dimensions				Stud Diameter (In.)	Performance Pounds	
		Steel Thickness (In.)	Height H (In.)	Cap Dia. (In.)	Washer Dia. D (In.)		Push-On Force	Min. Holding Strength
<b>14170</b>	100	.018	.205	.289	1/2	1/4(.250)	65	280
<b>14171</b>	100	.020	.236	.358	5/8	5/16(.312)	90	460
<b>*8719</b>	100	.020	.234	.419	11/16	3/8(.375)	70	380
<b>14172</b>	100	.025	.270	.431	3/4	3/8(.375)	90	700
<b>14173</b>	100	.030	.328	.504	7/8	7/16(.438)	150	960
<b>8665</b>	100	.030	.328	.567	15/16	1/2(.500)	150	800
<b>14174</b>	50	.031	.413	.693	1-3/16	5/8(.625)	230	1500

\*Nickel Plated

# Sec. 27

# MISCELLANEOUS ITEMS

## Push-Pull Controls

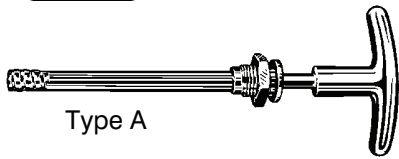

Type A

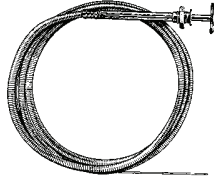

Type B

### 20242

Type A  
6' Long  
Chrome T-Handle  
Twist To Lock  
7/16"-20 Body Thread  
Wire Diameter: .072"

### 14541

Type B  
Choke Control  
5' Long  
Black Knob  
3/8"-24 Body Thread  
Wire Diameter: .047"

### 20243

Type B  
Choke Control  
8' Long  
Black Knob  
3/8"-24 Body Thread  
Wire Diameter: .054"

UNIT PACKAGE: 1

UNIT PACKAGE: 1

UNIT PACKAGE: 1

## Mechanics Wire

Soft Annealed, Black Steel Wire



## Perforated Hanger Strap

Hot Rolled Galvanized Steel



### 14926

28 Gauge  
3/4" Wide x 10 Ft.

UNIT PACKAGE: 1 ROLL

### 14927

24 Gauge  
3/4" Wide x 10 Ft.

UNIT PACKAGE: 1 ROLL

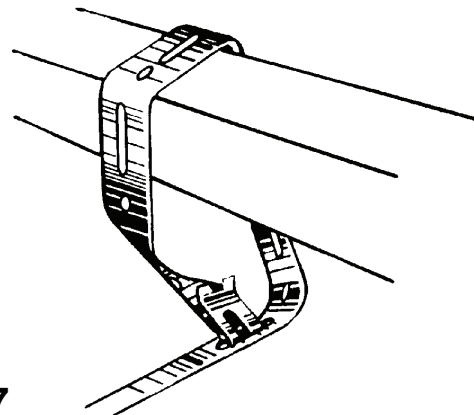

Auveco Part No.	Wire Gauge	Wire Length	Unit Pkg.
14205	18	2 LB. (332')	1 Spool
14206	16	2 LB. (192')	1 Spool
14207	18	5 LB. (831')	1 Spool
14208	16	5 LB. (480')	1 Spool

# MISCELLANEOUS ITEMS

**Sec. 27**

## Gas Pump Nozzles

Rebuildable



**16294**  
For Unleaded  
(No Lead) Gas  
Blue Scuff Guard  
1" Female Thread

UNIT PACKAGE: 1



**16296**  
"Throwaway Nozzle"  
For Unleaded  
(No Lead) Gas  
Blue Scuff Guard  
3/4" Female Thread

UNIT PACKAGE: 1



**16298**  
For Diesel Fuel  
Black Scuff Guard  
1" Female Thread

UNIT PACKAGE: 1

**16297**  
"Throwaway Nozzle"  
For Unleaded  
Red Scuff Guard  
3/4" Female Thread

UNIT PACKAGE: 1



## Gas Pump Swivel

C.A.R.B. Approved

Minimum Pressure Drop: Less Than 1PSI @ 10GPM

**16299**

3/4" Male x 3/4" Female

UNIT PACKAGE: 1



## Gas Pump Fail-Safe Breakaway Hose Coupling

C.A.R.B. Approved • 360 Degree Swivel • 1.5 Pound Pressure Drop @ 10GPM

**16303**

3/4" Diameter

UNIT PACKAGE: 1



## Expansion Plugs

Zinc Plated



Auveco Part No.	Size	Type	Unit Pkg.
3937	1/2"	Concave	100
3938	5/8"	Concave	100
3939	3/4"	Concave	100
3941	15/16"	Concave	100
3942	1"	Concave	100
3944	1-1/8"	Concave	100
3945	1-3/16"	Concave	100
3946	1-1/4"	Concave	100
3947	1-3/8"	Concave	100
3949	1-5/8"	Concave	50
3950	1-3/4"	Concave	50
3952	7/16" O.S.	Cup	25
3953	1/2"	Cup	25
3956	5/8"	Cup	25
3957	3/4"	Cup	25
3958	7/8"	Cup	25
15212	15/16"	Cup	50

Auveco Part No.	Size	Type	Unit Pkg.
3960	1"	Cup	25
3961	1-1/8"	Cup	25
3962	1-7/32"	Cup	25
3963	1-1/4"	Cup	25
3964	1-3/8"	Cup	25
3965	1-1/2"	Cup	25
3966	1-5/8"	Cup	25
3967	1-3/4"	Cup	25
3968	1-7/8"	Cup	25
3969	1-15/16"	Cup	25
3971	2"	Cup	25

See Page 74 for Metric Expansion Plugs. For an Assortment of Expansion Plugs, See Kit No. 6067

**MISCELLANEOUS ITEMS**

**Battery Hold Down Bolts**

Not Actual Size



**14461**

(Chry: 2534814)  
Plain

Battery Hold Down Bolt w/Nut  
Size: 1/4"-20 x 7"  
Thread Length: 2"

UNIT PACKAGE: 10

Not Actual Size



**8964**

(Ford: B5A-10756-B)  
Plain

Battery Hold Down Bolt w/Nut  
Size 5/16"-18 x 10"  
Thread Length 2-3/4"

UNIT PACKAGE: 10

Not Actual Size



**8971**

(Chry: 2074089)  
Plain

Inside Battery Hold Down Bolt w/Nut  
Size 1/4"-20 x 9"  
Thread Length 2-1/4"

UNIT PACKAGE: 10

Not Actual Size



**10643**

Zinc

Battery Hold down Bolt w/Nut  
Size 5/16"-18 x 12"  
Thread Length 6"

UNIT PACKAGE: 10

Not Actual Size



**8963**

(GM: 3688699)  
Plain

Battery Hold Bolt w/Nut  
Size: 5/16"-18 x 8"  
Thread Length: 1"

UNIT PACKAGE: 10

Not Actual Size



**10644**

Plain

Battery Hold Down Bolt w/Nut  
Size: 3/8"-16 x 10"  
Thread Length: 3"

UNIT PACKAGE: 10