

BUNA "N" RUBBER "O" RINGS

Sec. 16

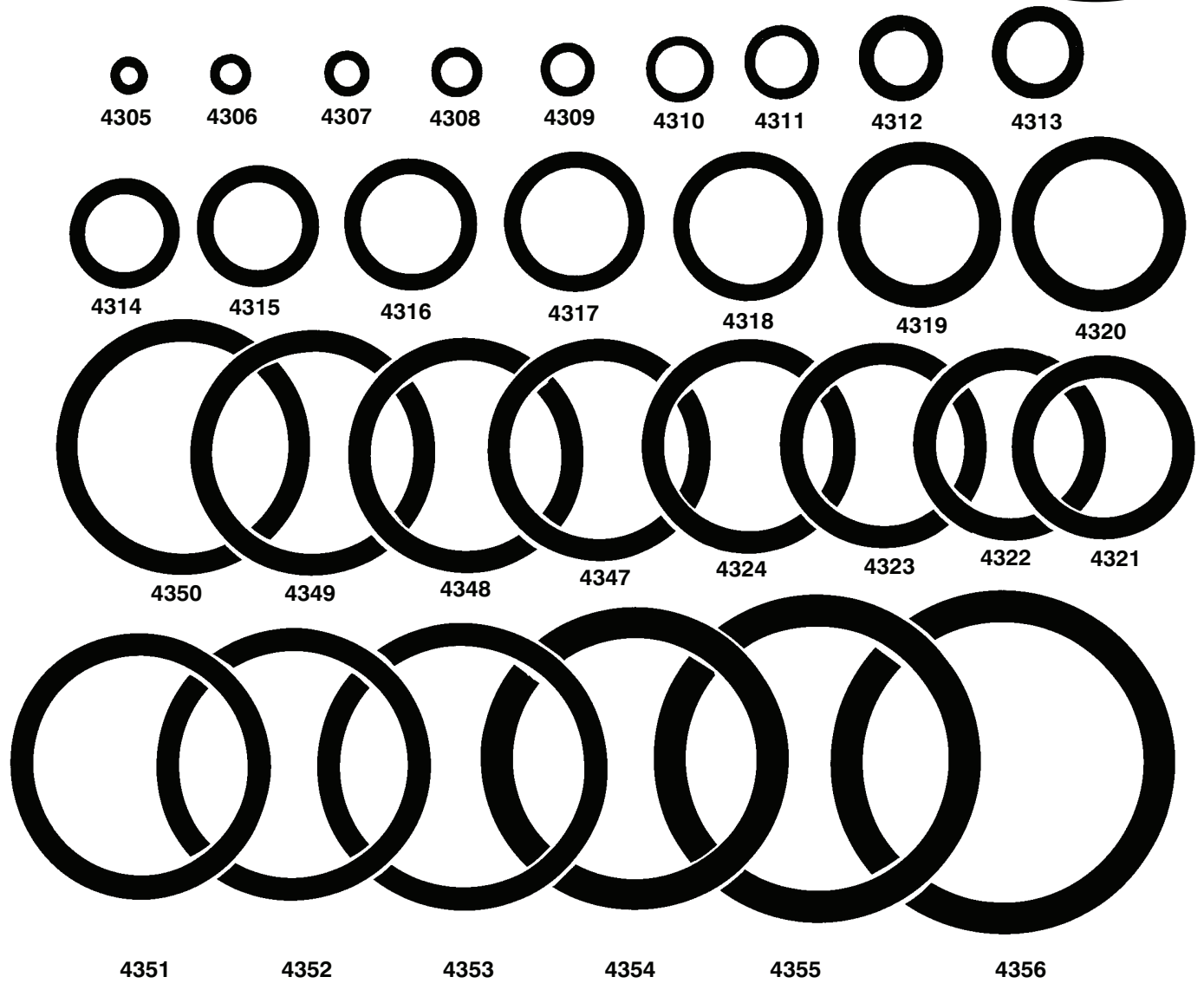

THICKNESS
 4305 thru 43111/16"
 4312 thru 43183/32"
 4319 thru 43531/8"
 4354 thru 435613/64"
 Temperature Rating: 70 hours @ 100°C

Auveco Part No.	Ind. Std.	I.D.	O.D.	Unit Pkg.	Auveco Part No.	Ind. Std.	I.D.	O.D.	Unit Pkg.
4305	006	1/8"	1/4"	50	4320	211	13/16"	1-1/16"	50
4306	007	5/32"	9/32"	50	4321	212	7/8"	1-1/8"	50
4307	008	3/16"	5/16"	50	4322	213	15/16"	1-3/16"	50
4308	009	7/32"	11/32"	50	4323	214	1"	1-1/4"	50
4309	010	1/4"	3/8"	50	4324	215	1-1/16"	1-5/16"	50
4310	011	5/16"	7/16"	50	4347	216	1-1/8"	1-3/8"	25
4311	012	3/8"	1/2"	50	4348	217	1-3/16"	1-7/16"	25
4312	110	3/8"	9/16"	50	4349	218	1-1/4"	1-1/2"	25
4313	111	7/16"	5/8"	50	4350	219	1-5/16"	1-9/16"	25
4314	112	1/2"	11/16"	50	4351	220	1-3/8"	1-5/8"	25
4315	113	9/16"	3/4"	50	4352	221	1-7/16"	1-11/16"	25
4316	114	5/8"	13/16"	50	4353	222	1-1/2"	1-3/4"	25
4317	115	11/16"	7/8"	50	4354	325	1-1/2"	1-7/8"	25
4318	116	3/4"	15/16"	50	4355	326	1-5/8"	2"	25
4319	210	3/4"	1"	50	4356	327	1-3/4"	2-1/8"	25

Sec. 16 METRIC BUNA "N" RUBBER "O" RINGS

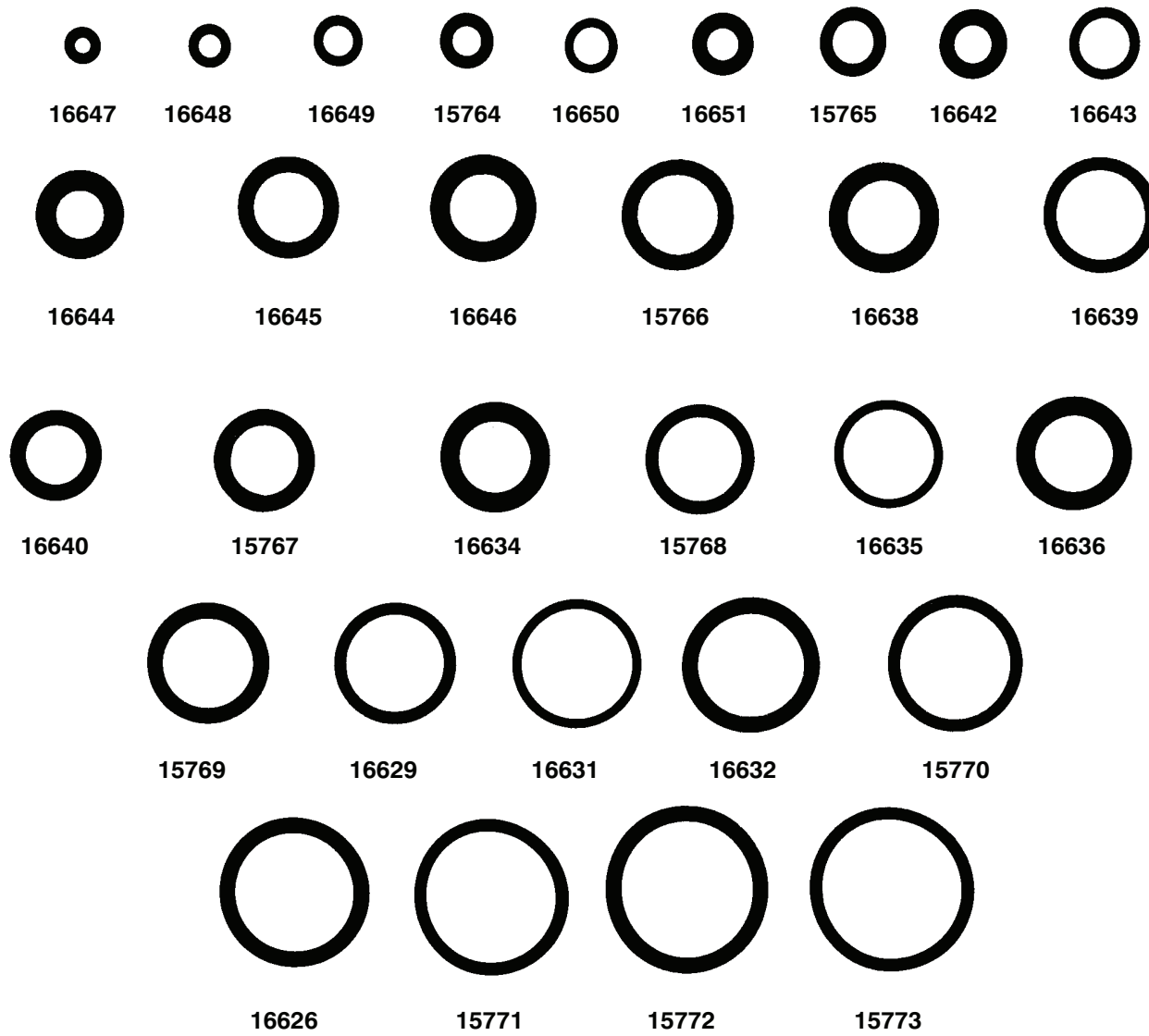

Auveco Part No.	I.D.	O.D.	Thickness	Unit Pkg.	Auveco Part No.	I.D.	O.D.	Thickness	Unit Pkg.
16647	2.2mm	5.4mm	1.6mm	50	15767	10mm	15mm	2.5mm	100
16648	3.1mm	6.3mm	1.6mm	50	16634	10mm	16mm	3mm	50
15764	4mm	8mm	2mm	100	16639	10.1mm	13.3mm	1.6mm	50
16649	4.1mm	7.3mm	1.6mm	50	16636	11mm	17mm	3mm	50
16651	4.3mm	9.1mm	2.4mm	50	15768	12mm	16mm	2mm	100
16650	5mm	8mm	1.5mm	50	16635	13mm	16mm	1.5mm	50
16642	5.3mm	10.1mm	2.4mm	50	15769	13mm	18mm	2.5mm	100
16644	5.6mm	10.4mm	2.4mm	50	16629	14mm	18mm	2mm	50
15765	6mm	10mm	2mm	100	16632	15mm	20mm	2.5mm	50
16643	7.1mm	10.3mm	1.6mm	50	16631	16mm	19mm	1.5mm	50
16646	7.6mm	12.4mm	2.4mm	50	15770	16mm	20mm	2mm	50
16645	8mm	12mm	2mm	50	16626	17mm	22mm	2.5mm	25
16638	8.3mm	13.1mm	2.4mm	50	15771	19mm	23mm	2mm	50
16640	8.6mm	13.4mm	2.4mm	50	15772	19mm	24mm	2.5mm	50
15766	9mm	13mm	2mm	100	15773	20mm	24mm	2mm	50

AIR CONDITIONING "O" RINGS

Sec. 16

For Use With R12 Refrigerant Only

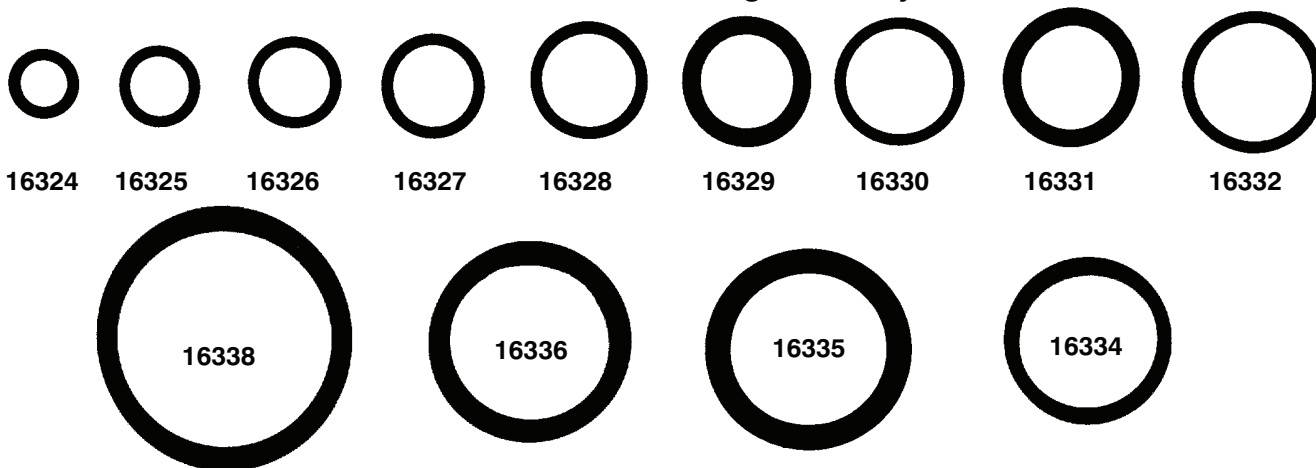

For original air conditioning systems. Not for use with R134A refrigerant.

Auveco Part No.	Ind. Std.	I.D.	O.D.	Thick-ness	Unit Pkg.	Auveco Part No.	Ind. Std.	I.D.	O.D.	Thick-ness	Unit Pkg.
16324	.010	1/4"	3/8"	1/16"	50	16332	.016	5/8"	3/4"	1/16"	50
16325	.011	5/16"	7/16"	1/16"	50	16334	.018	3/4"	7/8"	1/16"	25
16326	.012	3/8"	1/2"	1/16"	50	16335	.211	13/16"	1-1/16"	1/8"	10
16327	.013	7/16"	9/16"	1/16"	50	16336	.118	7/8"	1-1/16"	3/32"	25
16328	.014	1/2"	5/8"	1/16"	50	16338	.123	1-3/16"	1-3/8"	3/32"	10
16329	.112	1/2"	11/16"	3/32"	25						
16330	.015	9/16"	11/16"	1/16"	50						
16331	.113	9/16"	3/4"	3/32"	25						

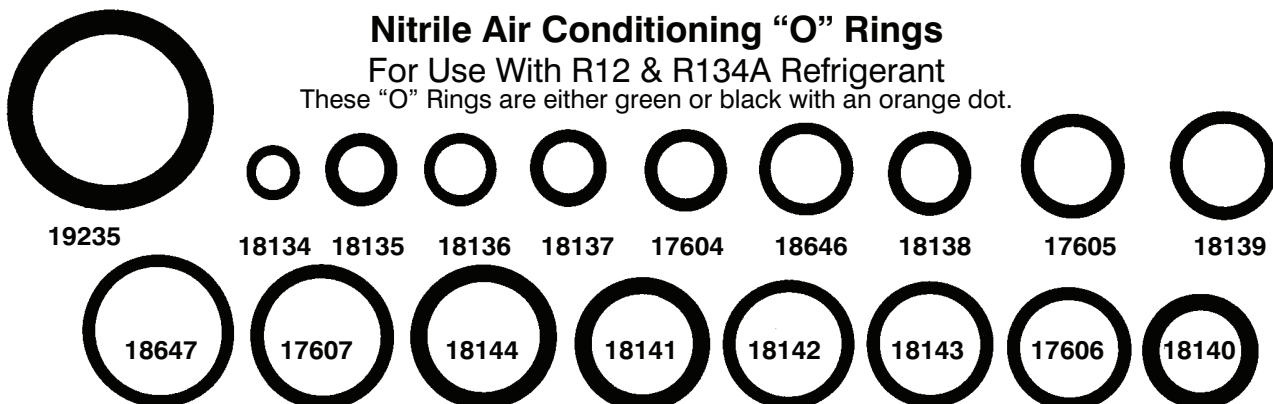

Nitrile Air Conditioning "O" Rings

For Use With R12 & R134A Refrigerant

These "O" Rings are either green or black with an orange dot.

Auveco Part No.	I.D.	O.D.	Thick-ness	OEM No.	Unit Pkg.
17604	.290"	.432"	.071"	Ford: 391396	25
18646	.375"	.500"	.063"		25
17605	.400"	.546"	.073"	Ford: 391397	25
17606	.509"	.655"	.073"	Ford: 391304	25
17607	.617"	.769"	.076"	Ford: 391305	15
18647	.688"	.813"	.063"		25
18134	4.5mm	7.3mm	1.4mm	Nissan: 92472-N8200	25
18135	6mm	9.6mm	1.8mm	Nissan: 92470-N8200	25
18136	6.5mm	9.5mm	1.5mm	Toyota: 90099-14044	25
18137	6.6mm	10.2mm	1.8mm	Acura: 80873-ST7-000	25
18138	7.7mm	11.3mm	1.8mm	Nissan: 92474-N8200	25
18140	10.7mm	15.5mm	2.4mm	Acura: 80872-ST7-000	25
				Nissan: 92475-W1000	
18139	10.8mm	14.4mm	1.8mm	Nissan: 92471-N8200	25
18141	13.3mm	18.1mm	2.4mm	Acura: 80871-ST7-000	25
18143	13.4mm	17.2mm	1.9mm	Toyota: 90099-14045	15
18142	14mm	17.6mm	1.8mm	Nissan: 92473-N8200	25
18144	14.8mm	19.6mm	2.4mm	Nissan: 92475-W2100	15
19235	13/16"	1-1/16"	1/8"		10

Sec. 16 BLUE NEOPRENE AIR CONDITIONING "O" RINGS

Teflon Coated • For Use With R134A & R12 Refrigerant

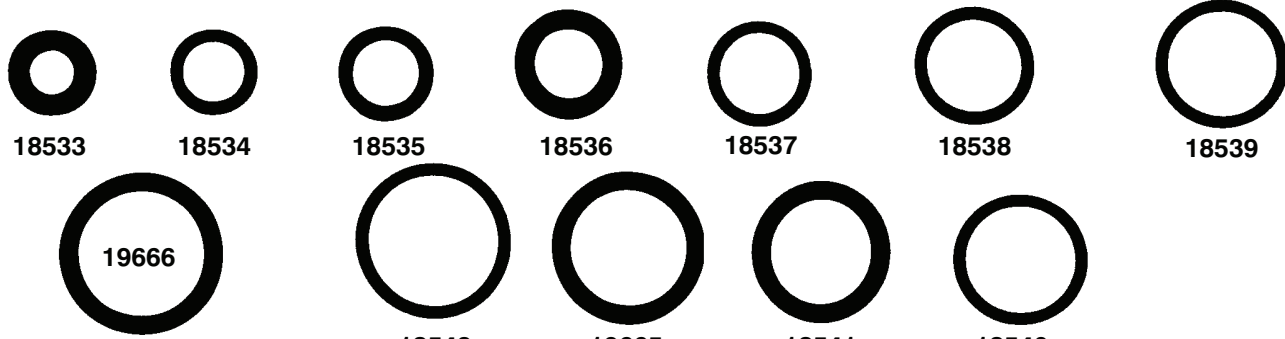

Auveco Part No.	Ind Std.	I.D.	O.D.	Thick-ness	Unit Pkg.	Auveco Part No.	Ind. Std.	I.D.	O.D.	Thick-ness	Unit Pkg.
185331081/4"7/16"3/32"25	185400159/16"11/16"1/16"25
185340115/16"7/16"1/16"25	185411139/16"3/4"3/32"25
185350123/8"1/2"1/16"25	196651145/8"13/16"3/32"25
185361103/8"9/16"3/32"25	1854301711/16"13/16"1/16"25
185370137/16"9/16"1/16"25	1966611511/16"7/8"3/32"25
185380141/2"5/8"1/16"25						
185391121/2"11/16"3/32"25						

Vinyl Grommets

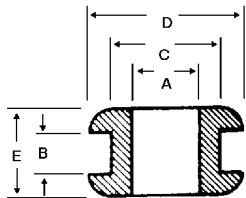

- Black Vinflex 163
- Exceptional Aging Qualities
- High Dielectric Properties
- Oil Resistant

- Non-Conductive
- Durometer Hardness 60
- Excellent Resistance to Ozone and Sunlight



Auveco Part No.	"A" Bore Diameter	"B" Groove Width	"C" Groove Diameter	"D" Outside Diameter	"E" Overall Thickness	Unit Pkg.
14764	1/4"	1/16"	3/8"	9/16"	1/4"	50
14765	5/16"	1/16"	7/16"	5/8"	1/4"	50
14767	1/2"	1/16"	5/8"	13/16"	9/32"	25

Rubber Grommets

Made of SBR Material
Durometer Hardness 60

All Packed 25

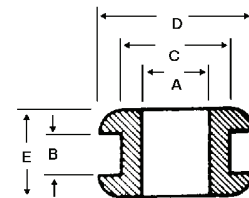

Auveco Part No.	A Bore Dia.	B Groove Width	C Groove Dia.	D Outside Dia.	E Overall Thickness	Auveco Part No.	A Bore Dia.	B Groove Width	C Groove Dia.	D Outside Dia.	E Overall Thickness
44081/8"3/32"3/8"1/2"5/16"	164563/8"1/16"5/8"7/8"11/32"
44105/32"1/16"1/4"3/8"3/16"	44253/8"1/16"1"1-1/4"1/4"
44115/32"3/32"1/4"7/16"3/8"	44263/8"1/4"5/8"7/8"1/2"
44133/16"1/16"5/16"1/2"1/4"	164577/16"1/16"9/16"3/4"1/4"
44143/16"3/32"9/32"3/8"5/16"	44281/2"3/32"3/4"31/32"9/32"
44153/16"1/4"5/16"7/16"3/8"	44291/2"3/32"25/32"1"11/32"
164541/4"1/16"3/8"1/2"3/16"	164581/2"1/8"3/4"1"1/2"
44171/4"1/16"7/16"5/8"3/16"	44301/2"1/4"13/16"1-1/16"1/2"
44181/4"1/16"1"1-1/4"1/4"	44315/8"1/8"7/8"1-1/8"3/8"
44195/16"1/16"7/16"9/16"3/16"	44325/8"1/16"7/8"1-1/8"5/16"
44205/16"1/16"9/16"13/16"5/16"	44333/4"1/16"15/16"1-1/8"1/4"
164555/16"1/16"3/4"1"5/16"	44343/4"1/16"1-1/16"1-3/8"3/8"
44215/16"1/8"9/16"13/16"3/8"	44353/4"1/16"1-1/4"1-5/8"1/4"
44225/16"1/4"9/16"13/16"1/2"	44363/4"1/4"1-1/4"1-5/8"7/16"
44233/8"1/16"1/2"5/8"9/32"						

GROMMETING & TIRE VALVES

Flexible Serrated Polyethylene Grommeting (Natural Color)

Grommeting is primarily used to protect wires and cables from sharp panel edges. Wires that are routed through knock-outs or over sharp edges need to be prevented from chafing against those edges. Grommeting can also be used to protect the edges of glass, sheet metal, wood panels, or other sheet-form materials. Depending on the panel thickness of the application, grommeting may grip tightly by itself—if not, a touch of epoxy will keep it in place.

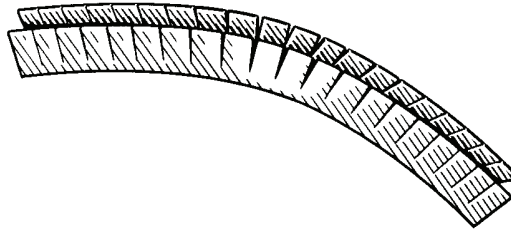
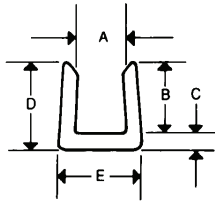

Auveco Part No.	"A" Max. Panel Thickness	"B"	"C"	"D"	"E"	Unit Pkg.
15974	.040"	.150"	.040"	.190"	.125"	100FT.
15975	.052"	.150"	.040"	.190"	.125"	100FT.
15976	.062"	.155"	.045"	.200"	.170"	100FT.
15977	.085"	.155"	.045"	.200"	.170"	100FT.
15978	.100"	.175"	.045"	.220"	.210"	100FT.
15979	.125"	.175"	.045"	.220"	.210"	100FT.
15980	.187"	.222"	.045"	.270"	.275"	100FT.

TUBELESS TIRE VALVES



1-1/4" Long
29/64" Rim Hole
(TR413)

Auveco No. **10184** - U.P. 5
 Auveco No. **10191** - U.P. 25
 Auveco No. **10192** - U.P. 100

1-1/4" Long
5/8" Rim Hole
(TR415)

Auveco No. **10204** - U.P. 100

2" Long
29/64" Rim Hole
(TR418)

Auveco No. **10186** - U.P. 5
 Auveco No. **10197** - U.P. 25
 Auveco No. **10198** - U.P. 100

Sec. 16

SPONGE WEATHERSTRIPS

Peel-Bak Adhesive Neoprene Sponge Weatherstrip

A light-weight closed cell sponge material, Peel-Bak is an easy to apply type of weatherstrip for auto and household use. May also be used on boats, refrigerators or any place a weatherproof, permanent seal is required. Simple to use - just peel back the liner tape and press into place. No cement or tacking required. Surface must be clean and dry.

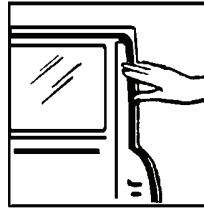
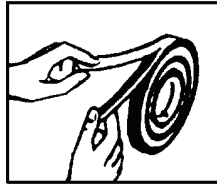

Press On
Clean Dry
Surface

Thickness	Width	10 Ft. Roll Auveco Part No.	50 Ft. Roll Auveco Part No.
5/32"	3/8"	4800	4850
5/32"	1/2"	4801	4851
5/32"	5/8"	4802	
5/32"	3/4"	4803	4852
5/32"	1"	4804	4853
5/16"	3/8"	4805	4854
5/16"	1/2"	4806	4855
5/16"	5/8"	4807	
5/16"	3/4"	4808	4856
5/16"	1"	4809	4857
7/16"	3/8"	4810	4858
7/16"	1/2"	4811	4859
7/16"	3/4"	4812	4860
7/16"	1"	4813	4861

EXACT SIZE PROFILES

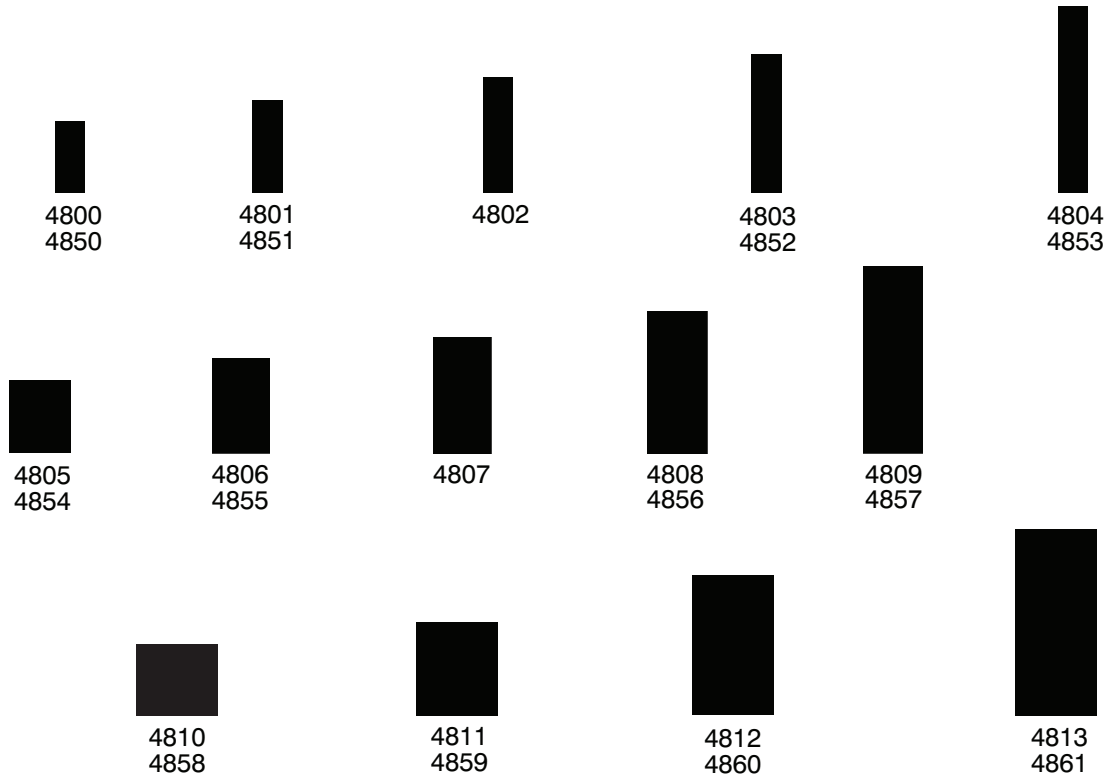

PVC FOAM ADHESIVE WEATHERSTRIPS

Sec. 16

A low density, PVC (polyvinyl chloride) foam weatherstrip with a permanent acrylic adhesive for easy application even on irregular or curved surfaces. Seals out air, moisture, dust and light as well as cushioning against vibration and noise. Remains flexible at -20° C to 80° C (-4° F to 176° F). Light gray in color.

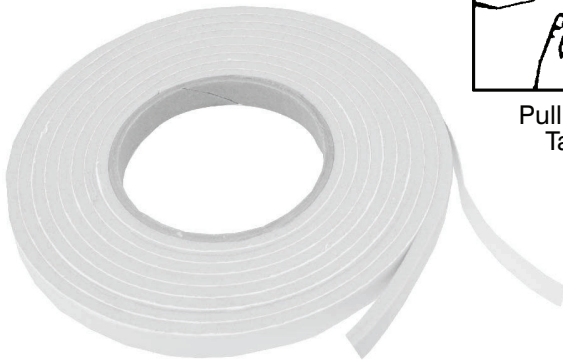

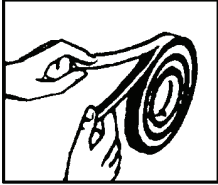

Pull Back
Tape

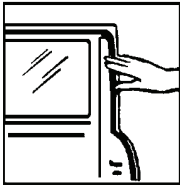

Press on Clean Dry
Surface

Thickness	Width	10 Ft. Roll Auveco Part No.	25 Ft. Roll Auveco Part No.
3/16"	1/2"	20912	20913
5/16"	3/4"	20914	20915
5/16"	1"	20916	20917
7/16"	3/4"	20918	20919
7/16"	1"	20920	20921

EXACT SIZE PROFILES

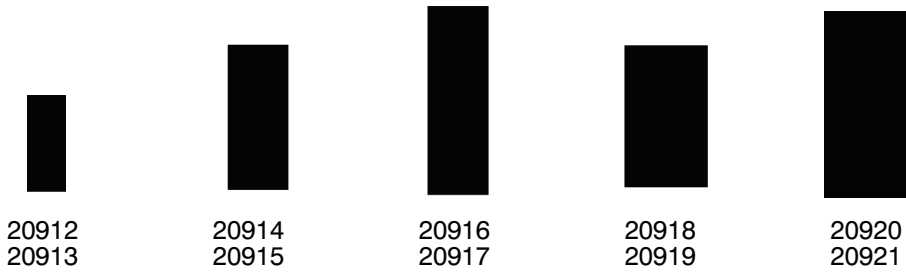

Pickup Truck Cap Weatherstrip Tape

A closed-cell foam weatherstrip tape that's used on the bottom lip of the cap or the truck's flange to form a moisture, dust and vibration resistant seal. Features an aggressive acrylic adhesive.



**Exact Size
Profile**



20922

3/16" Thick x 1-1/4" Wide x 30 Feet Long
Color: Light Gray

UNIT PACKAGE: 1 Roll

Sec. 16

SPONGE RUBBER WEATHERSTRIPS

ACTUAL SIZE ILLUSTRATIONS -EPDM CLOSED CELL

Light Weight -Weather Resistant

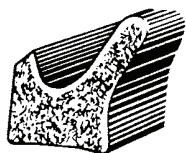

4675 UNIT PACKAGE: 50 Ft.
16390 UNIT PACKAGE: 15 Ft.

Door Flange Weatherstrip
GM, Ford & Chrysler
Cars & Trucks



4731

Door Flange Weatherstrip
GM 1954-53
Universal

UNIT PACKAGE: 50 Ft.



4744 UNIT PACKAGE: 50 Ft.
16391 UNIT PACKAGE: 15 Ft.

Door Flange Weatherstrip
GM: 1955-On

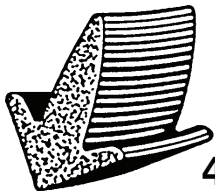

4707

Door Flange Weatherstrip
Chrysler 1954-50
Ford 1958-50

UNIT PACKAGE: 50 Ft.

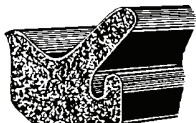

4745 UNIT PACKAGE: 50 Ft.
16392 UNIT PACKAGE: 15 Ft.

Door Flange Weatherstrip
Ford 1955-On



4746 UNIT PACKAGE: 50 Ft.
16393 UNIT PACKAGE: 15 Ft.

Door Flange Weatherstrip
Chrysler 1958-On

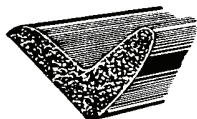

4747

Door Inner Belt Weatherstrip
All Cars 1970-55

UNIT PACKAGE: 50 Ft.

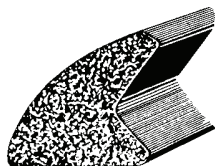

4742

Trunk & Lid Weatherstrip
GM 1959-On
Ford 1949-On
Studebaker 1967-55

UNIT PACKAGE: 50 Ft.

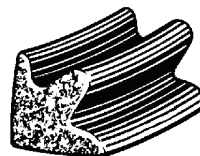

16890 UNIT PACKAGE: 25 Ft.
16891 UNIT PACKAGE: 50 Ft.

Door Flange Weatherstrip
Ford 1956-53



4703 UNIT PACKAGE: 50 Ft.
16395 UNIT PACKAGE: 15 Ft.

Trunk & Rear Deck Gutter
Weatherstrip
GM

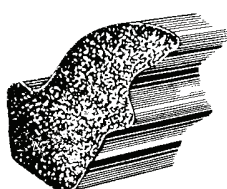

4749 UNIT PACKAGE: 50 Ft.
16394 UNIT PACKAGE: 15 Ft.

Deck Lid Weatherstrip
GM 1956-On

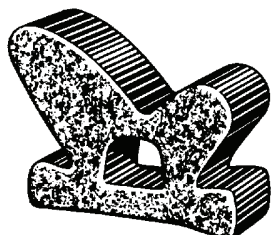

16892

Roof Rail Weatherstrip
GM 1977-68

UNIT PACKAGE: 25 Ft.



SPONGE RUBBER WEATHERSTRIPS

Sec. 16

ACTUAL SIZE ILLUSTRATIONS -EPDM CLOSED CELL
Light Weight -Weather Resistant

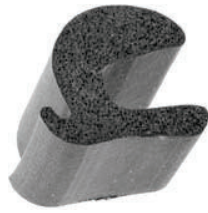

4743

Trunk Weatherstrip
Universal

UNIT PACKAGE: 35 Ft.



4750

(C5AZ-6243720-B)

Deck Lid Weatherstrip
Ford 1956-On

UNIT PACKAGE: 50 Ft.



16524

Door Seal Weatherstrip
GM 1972-64

UNIT PACKAGE: 50 Ft.

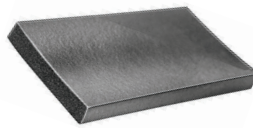

4740

19341

**Extruded Closed Cell
Sponge Rubber**

Will not absorb water or
moisture. Without Cement.

19341 1/8" Thick -3/4" Wide

4740 1/8" Thick -1-1/2" Wide

UNIT PACKAGE: 25 Ft.
(One Size)

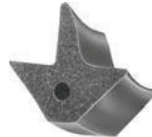

20928

Door Flange, Trunk & Tail Gate
Weatherstrip
With 3/32" Dia. Hole
Universal

UNIT PACKAGE: 25 FT.



16525

Door Seal Weatherstrip
GM 1963-55

UNIT PACKAGE: 50 Ft.



20929

Door Flange, Trunk & Tail Gate
Weatherstrip
With 1/8" Dia. Hole
Universal

UNIT PACKAGE: 25 Ft.



4736



4737



4738



**Closed Cell
Half Round
Sponge Rubber**

47361/4" Half Round

47373/8" Half Round

47381/2" Half Round

UNIT PACKAGE: 50 Ft.
(One Size)



4654



4655



4656

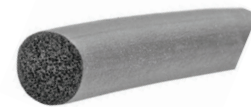

**Closed Cell
Sponge Rubber Windlace Cord**

Flexible filler for cloth covered windlace on door and
windshield pillars and door bottoms.

46541/4" Diameter

46553/8" Diameter

46561/2" Diameter

UNIT PACKAGE: 50 Ft.
(One Size)

Sec. 16

RUBBER BUMPERS & GROMMETS

(ILLUSTRATIONS ACTUAL SIZE)



4280
(3745361, 3762180)
License Plate Bumper
GM

UNIT PACKAGE: 25



4406
Brake Adjusting Screw
Hole Rubber Plug
Fits 5/16" x 1" Hole

UNIT PACKAGE: 25

Please Order
In Unit Package
Quantities
Not Number
Of Pieces



4260
(17562)
Windshield Wiper Rubber Grommet
1 1/32" I.D.
5/8" O.D.
3/16" Thick
Ford

UNIT PACKAGE: 25



4246
(357811)
Gas Tank Lid Rubber Bumper
Ford

UNIT PACKAGE: 25



4242
(4137121)
Trunk, Rear Deck Lid, & Hood
Bumper
GM

UNIT PACKAGE: 25



4243
(513388)
Hood To Ledge Bumper
GM

UNIT PACKAGE: 25



4265
(3711168)
Door Lock Striker Plate,
Window Glass Stop
& License Plate Bumper
GM

UNIT PACKAGE: 25



4188
(4081765)
Door & Quarter Glass
And Door Opening Header Bumper
GM

UNIT PACKAGE: 25



4237
(3664645)
General Purpose
GM

UNIT PACKAGE: 25



4235
(3688811)
Hood Top Panel Side
Bumper To Fender
GM

UNIT PACKAGE: 25



4248
(16758)
General Purpose
Ford

UNIT PACKAGE: 25



4258
(352839)
General Purpose
Ford

UNIT PACKAGE: 25

RUBBER BUMPERS & GROMMETS

Sec. 16

(ILLUSTRATIONS ACTUAL SIZE)



4447
(7724826)

Trunk Lid Bumper
GM

UNIT PACKAGE: 10



13967

General Purpose
Head: 1/2" O.D. x 5/16" Long
Fits Into 1/4" Hole
Durometer: 55-65

UNIT PACKAGE: 25



4446
(4872948)

Trunk Lid Bumper
GM

UNIT PACKAGE: 25



4264
(4564974)

Front Door Bumper
GM

UNIT PACKAGE: 25



4441
(4565591,
7637192,
20376243)

Front Door Bumper
GM

UNIT PACKAGE: 25



4357
(C60Z-16758-A)

Hood to Fender Bumper
Ford

UNIT PACKAGE: 25



4233
(3655015)

General Purpose
GM

UNIT PACKAGE: 25



4273
(B7A-16758-A)

Hood Bumper
Ford

UNIT PACKAGE: 25



4369
(3900684,
15029828)

Pillar Bumper
GM Trucks

UNIT PACKAGE: 25



4249
(1304225)

General Purpose
GM

UNIT PACKAGE: 25



4250
(3693292)

Glove Box Door Bumper
GM

UNIT PACKAGE: 25



4155
(16758A)

General Purpose
Ford

UNIT PACKAGE: 25



4244
(972724)

General Purpose
Chrysler

UNIT PACKAGE: 25



4204
(4023030)

General Purpose
Ford & Chrysler

UNIT PACKAGE: 25



4240
(4563173,
4565415)

Door Bumper
GM

UNIT PACKAGE: 25



4236
(3689084)

General Purpose
GM

UNIT PACKAGE: 25

Sec. 16

RUBBER BUMPERS & GROMMETS

(ILLUSTRATIONS ACTUAL SIZE)



4281
(4721222)

Trunk Lid Bumper
GM

UNIT PACKAGE: 25



4266
(3760155)

Hood & Grille Bumper
GM

UNIT PACKAGE: 25



19340
(3538281)
Rubber

Air Inlet Screen
Rubber Retainer
Head Diameter: 1"
Stem Length: 5/16"
Fits Into 1/4" Hole
Cadillac DeVille,
Eldorado & Seville
1992-On

UNIT PACKAGE: 20



20698
Black Rubber

Cigarette Lighter
Safety Plug
Used to replace unwanted
cigarette lighters.
Prevents accidental shocks
and burns.
Discourages smoking in the car.
The tight fit deters removal.

UNIT PACKAGE: 2



15453
(472450, 12338034)

Hood Bumper
GM X Cars 1980-On
Across The Flats: 1"
Diameter: 15/16"
Overall Length: 1-29/32"

UNIT PACKAGE: 10



4474
(400764, 400765)

5/16-18 x 2-1/8"
Hood Adjusting Bolt & Bumper
GM

UNIT PACKAGE: 5

4473

Same as 4474
except for packing
UNIT PACKAGE: 10



16849
(Not Supplied Separately By O.E.M.)
Nylon

Hood Adjustment Nut
Ford 1989-On
M6-1.0 Threaded Insert

UNIT PACKAGE: 10



16850
(Not Supplied
Separately By O.E.M.)
Zinc

Hood Adjustment Bumper
Ford 1989-On
M6-1.0 x 44mm
23mm Hex

UNIT PACKAGE: 5



16832
(E83Z-16758-A)

Hood Adjustment Nut & Bumper
Ford 1989-On

UNIT PACKAGE: 2 Sets

**Self-Adhesive
Bumpers**

Clear modified PVC material



15984

Diameter: 1/2"
Height: 9/64"
Cylindrical Concavity

UNIT PACKAGE: 50

Rubber Caps

(Special Heat Resistant EPDM Rubber)



Can be used for capping lines and hoses while testing carburetors, emission control systems, vacuum lines, etc.



Auveco Part No.	Fits Tube O.D.	Inside Length	Unit Pkg.
12209	1/8"	9/16"	25
4440	3/16"	9/16"	25
16264			100
19000	3/16"	1-1/4"	25
4439	1/4"	9/16"	25
19001	1/4"	1-1/4"	25

Auveco Part No.	Fits Tube O.D.	Inside Length	Unit Pkg.
19002	5/16"	9/16"	25
12907	5/16"	1-1/4"	25
12210	3/8"	31/32"	25
19003	3/8"	1-1/2"	25
12908	1/2"	11/16"	10

Vinyl Vacuum Caps



Can be used for capping lines and hoses while testing carburetors, emission control systems, vacuum lines, etc. Color coded for size identification.

Auveco Part No.	I.D.	Fits Tube O.D.	Color	Length	Unit Pkg.
18202	1/8"	3/16"	Blue	5/8"	50
18203	3/16"	1/4"	Red	5/8"	50
18204	1/4"	5/16"	White	5/8"	50
18205	5/16"	3/8"	Black	5/8"	50

Rubber Hold Down Straps With Hooks



Auveco Part No.	Length	Span Range	Unit Pkg.
4448	9"	15" to 20"	10
4449	15"	20" to 30"	10
4450	20"	30" to 40"	10
4451	31"	40" to 55"	10

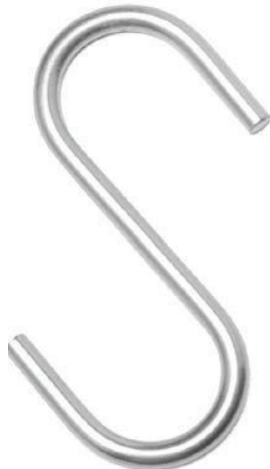

11298

Galvanized

3/16" x 3" - "S" Hook
Used with Auveco Rubber Hold Down Straps No. 4448, 4449, 4450 and 4451

UNIT PACKAGE: 50

11299

Same As 11298
Except For Packing

UNIT PACKAGE: 100



SEALS AND CHANNELS

DOOR SEALS

Years	Vehicle	Application	O.E.M. Number	Auveco Part No.
1991-73	Blazer, Jimmy & Suburban	Side Rear-Driver & Pass. Side	15606409, 15227654, 15227655	20792
1987-73	Pickup	Driver & Passenger Side	15606409, 15227654, 15227655	20792

WINDOW CHANNELS

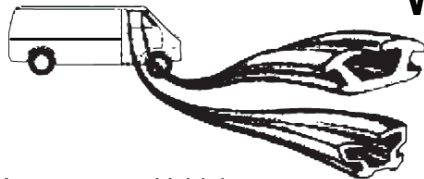

Years	Vehicle	Application	O.E.M. Number	Auveco Part No.
1991-73	Blazer, Jimmy & Suburban	Complete Glass Run with metal clip Front – Driver Side	14027777	20793
1991-73	Blazer, Jimmy & Suburban	Complete Glass Run with metal clip Front-Passenger Side	14027778	20794
1987-73	Pickup	Complete Glass Run with metal clip Front-Driver Side	14027777	20793
1987-73	Pickup	Complete Glass Run with metal clip Front-Passenger Side	14027778	20794



BELT WEATHERSTRIPS

Years	Vehicle	Application	O.E.M. Number	Auveco Part No.
1991-81	Blazer, Jimmy & Suburban	Inner-Driver Side	15569071	20797
1991-81	Blazer, Jimmy & Suburban	Inner-Passenger Side	15569072	20798
1991-73	Blazer, Jimmy & Suburban	Outer-Driver Side	14027775	20799
1991-73	Blazer, Jimmy & Suburban	Outer-Passenger Side	14027776	20800
1987-81	Pickup	Inner-Driver Side	15569071	20797
1987-81	Pickup	Inner-Passenger Side	15569072	20798
1987-73	Pickup	Outer-Driver Side	14027775	20799
1987-73	Pickup	Outer-Passenger Side	14027776	20800
1980-73	Pickup, Jimmy, Blazer & Suburban	Inner-Driver Side	470433	20795
1980-73	Pickup, Jimmy, Blazer & Suburban	Inner-Passenger Side	470434	20796



VENT WINDOW SEALS

Years	Vehicle	Application	O.E.M. Number	Auveco Part No.
1980-73	Pickup, Jimmy, Blazer & Suburban	Front Driver Side (Vertical sold separately)	6271903	20801
1980-73	Pickup, Jimmy, Blazer & Suburban	Front Passenger Side (Vertical sold separately)	6271904	20803
1980-73	Pickup, Jimmy, Blazer & Suburban	Rear Vertical-Driver Side	6271905	20802
1980-73	Pickup, Jimmy, Blazer & Suburban	Rear Vertical-Pass. Side	6271906	20804

GLASS SETTING CHANNELS

EPDM Dense Rubber

Sec. 16



4511

For 1/8" Glass
 Height 11/32"
 Width at Base 1/4"
 Inside Base 1/8"

Glass Setting Channel

UNIT PACKAGE: 50 Ft.



4515

For 1/4" Glass
 Height 9/16"
 Width at Base 25/64"
 Inside Base 1/4"

Glass Setting Channel

UNIT PACKAGE: 50 Ft.



4588

For 1/4" Glass
 Height 9/16"
 Width at Base 7/16"
 Inside Base 1/4"

Windshield And Rear Window
 Glass Setting Channel

UNIT PACKAGE: 50 Ft.



4512

For 3/16" Glass
 Height 7/16"
 Width at Base 27/64"
 Inside Base 3/16"

Windshield And Rear Window
 Glass Setting Channel

UNIT PACKAGE: 50 Ft.



4513

For 1/4" Glass
 Height 7/16"
 Width at Base 31/64"
 Inside Base 1/4"

Windshield And Rear Window
 Glass Setting Channel

UNIT PACKAGE: 50 Ft.



4516

For 3/16" Glass
 Height 7/16"
 Width at Base 3/8"
 Inside Base 3/16"

Glass Setting Channel

UNIT PACKAGE: 50 Ft.



4670

For 1/4" Glass

Windshield & Rear
 Window Glass
 Setting Channel
 And Weatherstrip
 Ford, Mercury Early Models

UNIT PACKAGE: 50 Ft.



4688

For 1/4" Glass

Rear Window Glass
 Setting Channel
 Chrysler Early Models

UNIT PACKAGE: 50 Ft.



4671

For 1/4" Glass

Rear Window Glass
 Setting Channel
 And Weatherstrip
 Chrysler - Early Models

UNIT PACKAGE: 50 Ft.

EPDM Rubber Weatherstrip For Glass

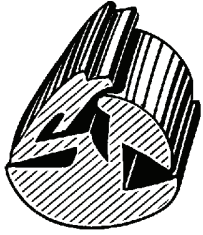

17509

Glass Thickness: 1/4"
Body Thickness: 1/16"
Self-Locking Type

UNIT PACKAGE: 50 Ft.

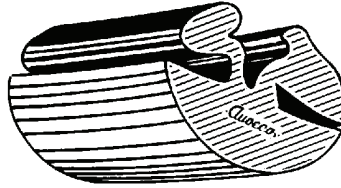

17513

Glass Thickness: 1/4"
Body Thickness: 1/8"
Bead Lock Type
Use With 17514

UNIT PACKAGE: 50 Ft.

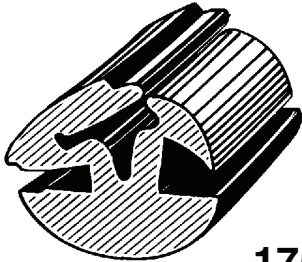

17510

Glass Thickness: 1/4"
Body Thickness: 1/8"
Self-Locking Type

UNIT PACKAGE: 50 Ft.

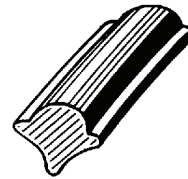

17514

Glass Thickness 1/4"
Locking Bead
Use With 17513

UNIT PACKAGE: 50 Ft.

Molded Dense Rubber



Tee Rubber
Concave Head

- 4530.....3/4".....9/32" Head
- 4531.....1".....9/32" Head

UNIT PACKAGE: 50 Ft.
(One Size)



4581

Windshield glass weatherstrip for 1/4" glass

UNIT PACKAGE: 50 Ft.

Universal Windshield & Rear Window Flex-Fit Rubber Moulding

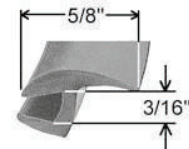

20342

A universal windshield rubber moulding for domestic and import vehicles. Made of EPDM rubber, this moulding contains a butyl bead that adheres to the glass during installation. The profile design allows for the moulding to attach easily to the glass edge and lay evenly on the vehicle body along straight areas and around corners.

Extruded with a metal filament to prevent stretching and shrinkage.

UNIT PACKAGE: 15 Feet