

Sec. 9

TEENUT® FASTENERS

Round Base -3 Rivet or Nail Holes for Assembly
 Material: Low Carbon Steel, Zinc Finish

For applications into materials of high density and where repeated bolt removal and replacement is expected.

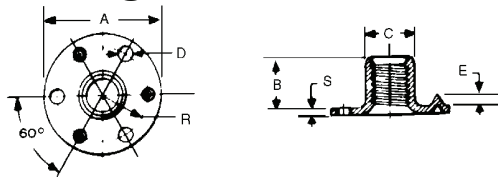

| Auveco No. | Thread Size | A | B | C | D +.005 | E | R | S | Unit Pkg. |
|--------------|-------------|-----|------|-----------|------------|------|-------|------|-----------|
| 18341 | 1/4-20 | 3/4 | 5/16 | .311/.306 | .098 | 5/64 | 19/64 | .050 | 50 |
| 2262 | 3/8-16 | 1 | 1/2 | .471/.466 | .145 | 5/64 | 5/64 | .075 | 100 |

Claw Prongs -Round Base

Material: Low Carbon Steel, Plain Finish

This Long Prong Teenut has six claw-like prongs that penetrate into wood, toe in, and grip so tightly that you have to drive it to back it out of its hole.



| Auveco No. | Thread Size | A | B | C | D | S | Unit Pkg. |
|--------------|-------------|-----|------|-----------|-------|------|-----------|
| 10729 | 10-24 | 3/4 | 9/32 | .232/.227 | 13/64 | .035 | 50 |
| 11324 | 1/4-20 | 3/4 | 5/16 | .294/.289 | 15/64 | .042 | 50 |
| 10730 | 1/4-20 | 3/4 | 7/16 | .294/.289 | 15/64 | .042 | 50 |
| 10731 | 5/16-18 | 7/8 | 3/8 | .369/.364 | 19/64 | .052 | 50 |
| 10732 | 3/8-16 | 1.0 | 7/16 | .448/.443 | 11/32 | .062 | 25 |

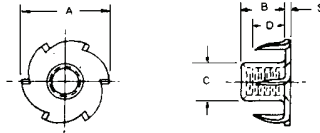

Claw Prongs -Slimline, Round Base

Material: Low Carbon Steel, Plain Finish

Recommended where superior retention in soft wood is required.



| Auveco No. | Thread Size | A | B | C | D | S | Unit Pkg. |
|--------------|-------------|------|------|-----------|-------|------|-----------|
| 11325 | 1/4-20 | 3/4 | 5/16 | .294/.289 | 15/64 | .042 | 100 |
| 11326 | 5/16-18 | 7/8 | 3/8 | .369/.364 | 19/64 | .052 | 50 |
| 11327 | 3/8-16 | 1.00 | 7/16 | .448/.443 | 11/32 | .062 | 25 |

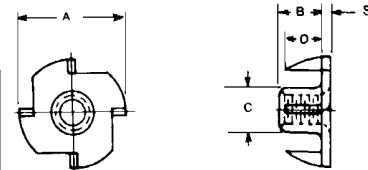

Claw Prongs -Slimline, Round Base

Material: 300 Series Stainless Steel, Plain Finish



| Auveco No. | Thread Size | A | B | C | D | S | Unit Pkg. |
|--------------|-------------|------|-------|--------|-------|-------|-----------|
| 17013 | 1/4-20 | 3/4" | 5/16" | 19/64" | 3/16" | .047" | 25 |

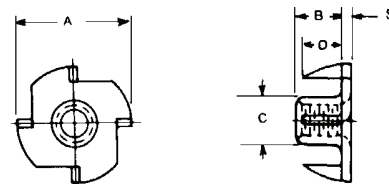

Straight Prongs -Round Base

Material: Low Carbon Steel, Plain Finish

This Teenut is recommended for thick material applications and applications requiring the top of the barrel to provide a bearing surface for mating parts.

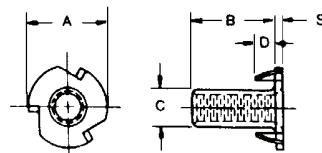

| Auveco No. | Thread Size | A | B | C | D | Type | S | Unit Pkg. |
|--------------|-------------|------|-------|-----------|-------|----------|------|-----------|
| 11328 | 6-32 | 9/16 | 15/64 | .164/.157 | 1/8 | 3 Prongs | .020 | 50 |
| 11331 | 10-32 | 3/4 | 9/32 | .232/.227 | 13/64 | 3 Prongs | .035 | 50 |
| 11332 | 1/4-20 | 3/4 | 5/16 | .311/.306 | 15/64 | 4 Prongs | .050 | 50 |

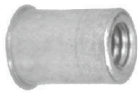

AUVECO THIN SHEET NUTSERT® INSERTS

Sec. 9

U.S.S., S.A.E. & Metric -Steel & Aluminum

Threaded Inserts For Thin Material

The Auveco Thin Sheet Nutsert® has been designed to provide a highly efficient method of securing threads from one side of the work in materials generally too thin to support threads. Its performance has been proven in plastic, aluminum, mild steel and fiberglass withstanding high loads without vibrating or loosening under extreme operating conditions. The Auveco Thin Sheet Nutsert® is a tension fastener with high pull out, insuring no rotation or vibration where a cover plate is used. The system's unique blind tooling installs TSNs at consistent rates using unskilled labor.

How It Works

The Thin Sheet Nutsert®, held securely by the tool, is placed into a prepared hole. Upon the tool's actuation, the threaded portion is pulled until the fastener's wall collapses radially outward, clinching it tight against the sheet. The tool is withdrawn, leaving the Thin Sheet Nutsert® ready to receive a bolt or screw. This complete operation takes only a few seconds and can be performed by anyone.



Strength Tests: Torque Strength -With an attaching part over the Thin Sheet Nutsert®, offering a bearing surface,

the TSN will remain intact past the point of the screw or bolt breaking (head torqued off). In almost all cases the threads of the TSN will remain undistorted and serviceable -an exception to this statement is when an extremely high tensile bolt is used.

Steel: 1010 Low Carbon Steel, Type 11 Class 3 with Zinc Plate, Clear Chromate

Aluminum: Aluminum Alloy 5056, Plain Finish, Metric Class 6H, U.S. Class 2B

To Set Nutserts®, Use Tool 11805 & Conversion Kits Listed On Page 92.

U.S.S. & S.A.E.

| Auveco Part No. | | Unit Pkg. | Thread Size After Installation | Recommended Grip Range | A Max. | B Max. | D Ref. | Hole Size | Drill Size |
|-----------------|----------|-----------|--------------------------------|------------------------|--------|--------|--------|------------|------------|
| Steel | Aluminum | | | | | | | | |
| 11310 | 13476 | 50 | 6-32 U.S.S. | .020-.080" | .249" | .410" | .287" | .250-.254" | 1/4" |
| 11315 | 13477 | 100 | 6-32 U.S.S. | .020-.080" | .249" | .410" | .287" | .250-.254" | 1/4" |
| 11311 | — | 50 | 8-32 U.S.S. | .020-.080" | .249" | .410" | .287" | .250-.254" | 1/4" |
| 11316 | — | 100 | 8-32 U.S.S. | .020-.080" | .249" | .410" | .287" | .250-.254" | 1/4" |
| 11312 | 13480 | 50 | 10-24 U.S.S. | .020-.130" | .280" | .465" | .320" | .281-.285" | 9/32" |
| 11317 | 13481 | 100 | 10-24 U.S.S. | .020-.130" | .280" | .465" | .320" | .281-.285" | 9/32" |
| 12978 | — | 50 | 10-32 S.A.E. | .020-.130" | .280" | .465" | .320" | .281-.285" | 9/32" |
| 12979 | — | 100 | 10-32 S.A.E. | .020-.130" | .280" | .465" | .320" | .281-.285" | 9/32" |
| 11313 | — | 25 | 1/4"-20 U.S.S. | .030-.165" | .347" | .610" | .415" | .375-.379" | 3/8" |
| 11318 | — | 100 | 1/4"-20 U.S.S. | .030-.165" | .347" | .610" | .415" | .375-.379" | 3/8" |
| 11314 | — | 25 | 5/16"-18 U.S.S. | .040-.200" | .499" | .720" | .540" | .500-.504" | 1/2" |
| 11319 | — | 100 | 5/16"-18 U.S.S. | .040-.200" | .499" | .720" | .540" | .500-.504" | 1/2" |
| 16785 | — | 15 | 3/8"-16 U.S.S. | .040-.200" | .499" | .720" | .540" | .500-.504" | 1/2" |

Regular Pitch Metric

| Auveco Part No. | | Unit Pkg. | Thread Size After Installation | Recommended Grip Range "GR" | A Max. | B Max. | D Ref. | Hole Size | Drill Size |
|-----------------|----------|-----------|--------------------------------|-----------------------------|------------------|------------------|------------------|-----------------------------|------------|
| Steel | Aluminum | | | | | | | | |
| 12980 | — | 50 | M4-.7 | .020-.080" .508/2.030mm | .249" 6.32mm | .410" 10.41mm | .287" 7.29mm | .250-.254" 6.35/6.45mm | 1/4" |
| 12981 | — | 100 | M4-.7 | .020-.080" .508/2.030mm | .249" 6.32mm | .410" 10.41mm | .287" 7.29mm | .250-.254" 6.35/6.45mm | 1/4" |
| 12982 | — | 50 | M5-.8 | .020-.130" .508/3.300mm | .280" 7.11mm | .465" 11.81mm | .320" 8.13mm | .281-.285" 7.14/7.24mm | 9/32" |
| 12983 | — | 100 | M5-.8 | .020-.130" .508/3.300mm | .280" 7.11mm | .465" 11.81mm | .320" 8.13mm | .281-.285" 7.14/7.24mm | 9/32" |
| 12984 | 13494 | 25 | M6-1.0 | .030-.165" .762/4.190mm | .374" 9.50mm | .610" 15.49mm | .415" 10.54mm | .375-.379" 9.53/9.63mm | 3/8" |
| 12985 | 13495 | 100 | M6-1.0 | .030-.165" .762/4.190mm | .374" 9.50mm | .610" 15.49mm | .415" 10.54mm | .375-.379" 9.53/9.63mm | 3/8" |
| 12986 | — | 25 | M8-1.25 | .040-.200" 1.020/5.080mm | .499" 12.67mm | .720" 18.29mm | .540" 13.72mm | .500-.504" 12.71/12.80mm | 1/2" |
| 12987 | — | 100 | M8-1.25 | .040-.200" 1.020/5.080mm | .499" 12.67mm | .720" 18.29mm | .540" 13.72mm | .500-.504" 12.71/12.80mm | 1/2" |

Sec. 9 LARGE FLANGE THIN SHEET NUTSERT® INSERTS



U.S.S., S.A.E. & Metric -Steel & Aluminum

The Large Flange system provides captive threads in materials too thin to independently support threads, or where costly tapping operations are to be eliminated. The Large Flange fastener can be used as a rivet to join materials that will ultimately have a separate component attached.

Materials: Low Carbon Steel, Zinc Plated
(Metric: Zinc & Yellow Plated)
Aluminum Alloy, Plain Finish

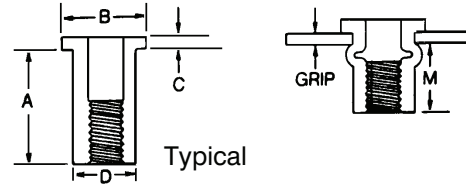

To Set 8-32, 10-24 and 10-32 Large Flange Nutserts®, use tool 11805 and conversion kits listed on page 92. 1/4"-20, 5/16"-18 and 3/8"-16 Large Flange Nutserts® require a pneumatic tool for installation. They **cannot** be set with 11805.

U.S.S. & S.A.E.

| Auveco Part No. | | Unit Pkg. | Thread Size | Grip Range | Hole Size | A +.015 | B +.015 | C (NOM) | D +.000 -.004 | M (Ref.) |
|-----------------|--------|-----------|--------------------|------------|------------|------------|------------|------------|---------------------|-------------|
| Aluminum | Steel | | | | | | | | | |
| 16177 | 16187 | 50 | 8-32 U.S.S. | .010-.075" | .221-.226" | .438" | .357" | .032" | .221" | .300" |
| 16178 | 16188 | 50 | 10-24 U.S.S. | .010-.080" | .250-.256" | .531" | .406" | .038" | .250" | .380" |
| 16179 | 16189 | 50 | 10-24 U.S.S. | .080-.130" | .250-.256" | .594" | .406" | .038" | .250" | .390" |
| 16180 | 16190 | 25 | 10-32 S.A.E. | .010-.080" | .250-.256" | .531" | .406" | .038" | .250" | .380" |
| | 16191 | 25 | 10-32 S.A.E. | .080-.130" | .250-.256" | .594" | .406" | .038" | .250" | .390" |
| 16182* | 16192* | 25 | 1/4"-20 U.S.S. | .020-.080" | .332-.338" | .625" | .475" | .058" | .332" | .450" |
| 16183* | 16193* | 25 | 1/4"-20 U.S.S. | .080-.140" | .332-.338" | .687" | .475" | .058" | .332" | .450" |
| 16184* | 16194* | 25 | 5/16"-18 U.S.S. | .030-.125" | .413-.423" | .750" | .665" | .062" | .413" | .505" |
| | 16195* | 25 | 5/16"-18 U.S.S. | .125-.200" | .413-.423" | .875" | .665" | .062" | .413" | .555" |
| 16789* | | 10 | 3/8"-16 U.S.S. | .030-.115" | .490-.500" | .844" | .781" | .088" | .490" | .585" |
| | 16788* | 10 | 3/8"-16 U.S.S. | .115-.200" | .490-.500" | .938" | .781" | .088" | .490" | .595" |

***Cannot be set with Auveco tool 11805**
Requires pneumatic tool

Regular Pitch Metric

| Auveco Part No. | | Unit Pkg. | Thread Size | Grip Range | Hole Size | A ±.015 | B ±.015 | C (NOM.) | D+.000 -.004 | M (Ref.) |
|-----------------|-------|-----------|-------------|------------------------|----------------|---------------|---------------|----------------|-----------------|-----------------|
| Aluminum | Steel | | | | | | | | | |
| | 16978 | 25 | M6-1.0 | .020-.118" .5-3.0mm | .358" 9.1mm | .630" 16mm | .510" 13mm | .059" 1.5mm | .356" 9mm | .450" 11.5mm |

NUTSERT® INSERTS U.S.S. & S.A.E. THREAD

The Auveco Nutsert® was developed to offer both the production-oriented designer and engineer a unique and versatile anchor nut-type insert for high-speed installation. This Auveco system gives the designer the option to design for **blind** or **open** applications, eliminating and simplifying his design problems.

The Auveco Nutsert® system provides a cost-saving method of installing clean, load-bearing steel threads in castings, fiberglass, fiberboard, plastics, wood or almost any ductile material more than .030" thick.

A simple hand tool installs the Nutsert®...it is ready for use in seconds... no finishing is required after installation.

Auveco Nutsert's® advanced design offers unlimited grip range in a minimum of sizes...inventory is minimized to one body dimension per thread size; ideally suited for blind...buried... and through holes. The ingenious "taper-lock" principle locks-in the Nutsert® preventing spin or twist; installs in flat or curved surfaces and is self-tightening with repeated use. The unique design of the installation tool eliminates marring of the parent material surface.

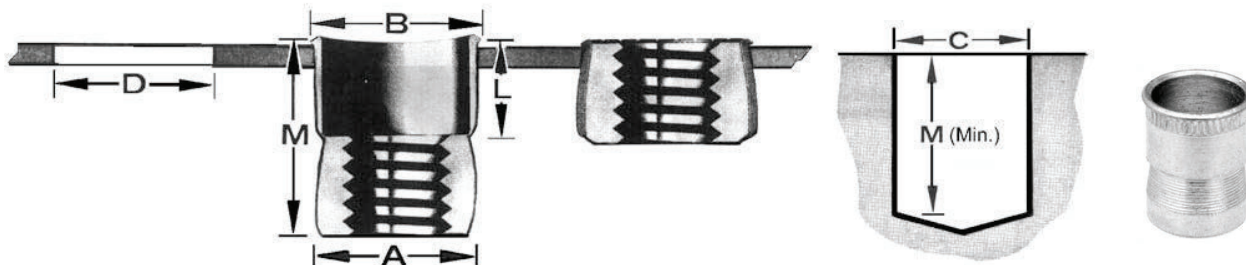

Material: Mild Steel, Tin Plated

Minimum Grip: .030"

To Set Nutserts® Use Tool 11805 & Conversion Kits Listed On Page 92.

| Auveco Part No. | Unit Pkg. | Thread Size (Class 2B) | A | B | L | M | C | D | Recommended Nominal Hole Size | Weight Per Thousand (In Lbs.) |
|--|-------------------|------------------------|-------|-------|-------|-------|---|---|-------------------------------|-------------------------------|
| 10264 10265 10266 | 25 100 1000 | 6-32 U.S.S. | .218" | .238" | .185" | .370" | Diameters vary with material density in blind application | Dependent upon material thickness and application | 7/32" | 1.50 |
| 10267 10268 10269 | 25 100 1000 | 8-32 U.S.S. | .249" | .264" | .185" | .370" | | | 1/4" | 2.00 |
| 10270 10271 10272 | 25 100 1000 | 10-24 U.S.S. | .280" | .300" | .185" | .370" | | | 9/32" | 2.25 |
| 10273 10274 10275 | 25 100 1000 | 10-32 S.A.E. | .280" | .300" | .185" | .370" | | | 9/32" | 2.25 |
| 10276 10277 10278 | 25 100 1000 | 1/4"-20 U.S.S. | .374" | .398" | .255" | .510" | | | 3/8" | 6.00 |
| 10279 10280 | 25 100 | 1/4"-28 S.A.E. | .374" | .398" | .255" | .510" | | | 3/8" | 6.00 |
| 10282 10283 10284 | 10 100 500 | 5/16"-18 U.S.S. | .499" | .524" | .305" | .610" | | | 1/2" | 12.87 |
| 10285 10286 | 10 100 | 5/16"-24 S.A.E. | .499" | .524" | .305" | .610" | | | 1/2" | 12.87 |
| 10288 10289 10290 | 10 50 100 | 3/8"-16 U.S.S. | .561" | .590" | .370" | .740" | | | 9/16" | 18.00 |

Sec. 9

NUTSERT® HAND TOOL & US & METRIC CONVERSION KITS



11805
Nutsert® Hand Tool
For regular and thin sheet Nutserts®
(Does not include any conversion kits)
Hand Tool only with wrench

UNIT PACKAGE: 1

Conversion Kits For
No. 11805 Gun

| Size | Use Tool 11805 with Auveco Conversion Kit Listed |
|-----------------|---|
| 6-32 U.S.S. | 11807 |
| 8-32 U.S.S. | 11808 |
| 10-32 S.A.E. | 11809 |
| 10-24 U.S.S. | 11810 |
| 1/4-20 U.S.S. | 11811 |
| 1/4-28 S.A.E. | 11812 |
| 5/16-18 U.S.S. | 11813 |
| 5/16-24 S.A.E. | 11814 |
| 3/8-16 U.S.S. | 11815 |
| M4-.7 | 12988 |
| M5-.8 | 12989 |
| M6-1.0 | 12990 |
| M8-1.25 | 12991 |
| Unit Package: 1 | |



11806

Nutsert® Tool Kit
(Complete in metal case)
Includes hand tool 11805, nose piece wrench, and conversion kits (nose
piece & mandrel) for the following sizes: 6-32, 8-32, 10-24, 10-32, 1/4-20 &
5/16-18.

UNIT PACKAGE: 1

16341

Metric Nutsert® Tool Kit
(Complete in metal case)
Includes hand tool 11805, nose piece wrench, and conversion kits (nose
piece & mandrel) for the following sizes: M4-.7, M5-.8, M6-1.0 (2 kits) &
M8-1.25.

UNIT PACKAGE: 1



15544

Mandrel Puller
Replacement Mandrel Puller
For Auveco 11805 Nutsert® Tool
1/4-28 Left-Hand Thread

UNIT PACKAGE: 1



THREAD REPAIR INSERTS

Here's the easy way to repair stripped threads.

Easy Installation/4 Simple Steps
Instructions Must Be Followed Exactly

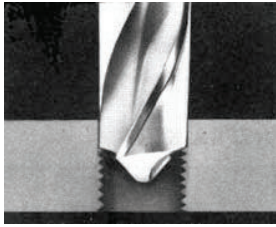

1 Drill out old threads, using standard drill.

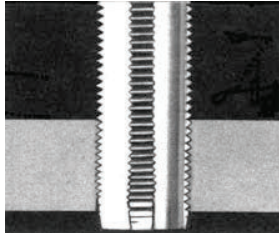

2 Tap new threads, using standard tap

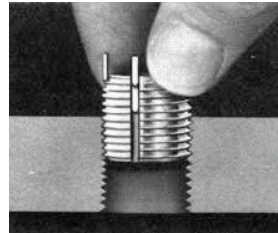

3 Screw in insert until slightly below surface. "kees" act as depth stop.

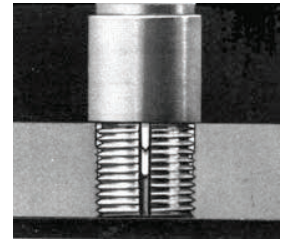

4 Drive "Kees" down with several light taps on installation tool.

Features:

- Installed with standard drills and taps.
- No pre-winder tool required.
- Impossible to cross thread while installing.
- No tang break-off.
- May be used in virtually any material...aluminum, magnesium, cast iron, cold rolled steel and plastic
- Provide high strength and reliability. One length per size provides maximum pullout strength.
- Positive mechanical lock against rotation.
- Breaks Grade 8 bolts in test after test.
- Easy to remove.



5 Installed Insert.

Thinwall Inserts

| Auveco Part No. | Internal Thread Size (Bolt Size) | External Thread Size | No. of Kees | Insert Length | Drill Size | Tap Size | Professional Installation Tool Part No. | Inserts Per Unit Package | | | | | | | | | | | | | |
|-----------------|----------------------------------|----------------------|-------------|---------------|------------|----------|---|--------------------------|----------|-------|-------|----------|----------|----------|----------|--------|---------|---------|----------|-------|-------|
| 12374 | 10-24 | 5/16"-18 | 2 | 5/16" | "I" | 5/16"-18 | | 4* | | | | | | | | | | | | | |
| 17515 | | | | | | | | 25 | | | | | | | | | | | | | |
| 17516 | | | | | | | | 50 | | | | | | | | | | | | | |
| 12375 | 10-32 | | | | | | | 5/16"-18 | 2 | 5/16" | "I" | 5/16"-18 | | 4* | | | | | | | |
| 17517 | | | | | | | | | | | | | | 25 | | | | | | | |
| 17518 | | | | | | | | | | | | | | 50 | | | | | | | |
| 12376 | 1/4"-20 | 3/8"-16 | 2 | 3/8" | "Q" | 3/8"-16 | 12394 | | | | | | | 4* | | | | | | | |
| 17519 | | | | | | | | | | | | | | 25 | | | | | | | |
| 17520 | | | | | | | | | | | | | | 50 | | | | | | | |
| 12377 | 1/4"-28 | | | | | | | 3/8"-16 | 2 | 3/8" | "Q" | 3/8"-16 | 12394 | 4* | | | | | | | |
| 17521 | | | | | | | | | | | | | | 25 | | | | | | | |
| 12378 | | | | | | | | | | | | | | 5/16"-18 | 7/16"-14 | 4 | 7/16" | "X" | 7/16"-14 | 12395 | 4* |
| 17522 | 25 | | | | | | | | | | | | | | | | | | | | |
| 17523 | 50 | | | | | | | | | | | | | | | | | | | | |
| 12379 | 5/16"-24 | 7/16"-14 | 4 | 7/16" | "X" | 7/16"-14 | 12395 | | | | | | | | | | | | | | 4* |
| 17524 | | | | | | | | 25 | | | | | | | | | | | | | |
| 12380 | | | | | | | | 3/8"-16 | 1/2"-13 | 4 | 1/2" | 29/64" | 1/2"-13 | | | | | | | | 12396 |
| 17525 | 25 | | | | | | | | | | | | | | | | | | | | |
| 17526 | 50 | | | | | | | | | | | | | | | | | | | | |
| 12381 | 3/8"-24 | | | | | | | 1/2"-13 | | | | | | 4 | 1/2" | 29/64" | 1/2"-13 | 12396 | 3* | | |
| 17527 | | 25 | | | | | | | | | | | | | | | | | | | |
| 12382 | | 7/16"-14 | 9/16"-12 | 4 | 9/16" | 33/64" | 9/16"-12 | | | | | | | | | | | | 12397 | 3* | |
| 17528 | 25 | | | | | | | | | | | | | | | | | | | | |
| 12383 | 7/16"-20 | | | | | | | | 9/16"-12 | 4 | 9/16" | 33/64" | 9/16"-12 | | | | | | | 12397 | 3* |
| 17529 | | | | | | | | | | | | | | | | | | | | | 25 |
| 12384 | | | | | | | | 1/2"-13 | | | | | | 5/8"-11 | 4 | 5/8" | 37/64" | 5/8"-11 | | | |
| 17530 | 15 | | | | | | | | | | | | | | | | | | | | |
| 17531 | 25 | | | | | | | | | | | | | | | | | | | | |
| 12385 | 1/2"-20 | 5/8"-11 | 4 | 5/8" | 37/64" | 5/8"-11 | | | | | | | | | | | | | 2* | | |
| 17532 | | | | | | | | | 15 | | | | | | | | | | | | |

*Contains Economy Drive Tool No. 12404

For an Assortment of Thin Wall Inserts, see Fix-Kit No. 6176

THREAD REPAIR INSERTS



Heavy Duty Thread Repair Inserts

| Auveco Part No. | Internal Thread Size (Bolt Size) | External Thread Size | No. of Kees | Insert Length | Drill Size | Tap Size | Professional Installation Tool Auveco Part No.† | Inserts Per Unit Package |
|-----------------|----------------------------------|----------------------|-------------|---------------|------------|-----------|---|--------------------------|
| 17238 | 10-24 | 3/8"-16 | 2 | .31" | "Q" | 3/8"-16 | ◆ | 4 |
| 17239 | 10-32 | | | | | | | 4 |
| 17240 | 1/4"-20 | 7/16"-14 | 2 | .37" | "X" | 7/16"-14 | ◆ | 4 |
| 17241 | 1/4"-28 | | | | | | | 4 |
| 17242 | 5/16"-18 | 1/2"-13 | 4 | .43" | 29/64" | 1/2"-13 | ◆ | 4 |
| 17243 | 5/16"-24 | | | | | | | 4 |
| 17244 | 3/8"-16 | 9/16"-12 | 4 | .50" | 33/64" | 9/16"-12 | ◆ | 3 |
| 17245 | 3/8"-24 | | | | | | | 3 |
| 17246 | 7/16"-14 | 5/8"-11 | 4 | .62" | 37/64" | 5/8"-11 | ◆ | 3 |
| 17247 | 7/16"-20 | | | | | | | 3 |
| 17248 | 1/2"-13 | 3/4"-16 | 4 | .62" | 45/64" | 3/4"-16 | ◆ | 2 |
| 17249 | 1/2"-20 | | | | | | | 2 |
| 16159 | 5/8"-11 | 7/8"-14 | 4 | .87" | 53/64" | 7/8"-14 | 16163 | 2 |
| 17533 | | | | | | | | 15 |
| 16160 | 5/8"-18 | | | | | | | 2 |
| 17534 | | | | | | | | 15 |
| 16161 | 3/4"-10 | 1-1/8"-12 | 4 | 1.12" | 1-1/16" | 1-1/8"-12 | 16164 | 2 |
| 17535 | | | | | | | | 10 |
| 16162 | 3/4"-16 | | | | | | | 2 |
| 17536 | | | | | | | | 10 |

† Not Packaged with the Thread Repair Inserts

◆ Professional tool not available. Can be set with 12404 Economy Drive Tool one kee at a time.

Metric Thread Repair Inserts®

| Auveco Part No. | Internal Thread Size (Bolt Size) | External Thread Size | No. of Kees | Insert Length | Drill Size | Tap Size | Professional Installation Tool Auveco Part No.† | Inserts Per Unit Package |
|-----------------|----------------------------------|----------------------|-------------|---------------|------------|----------|---|--------------------------|
| 12386 | M5-0.8 | M8-1.25 | 2 | .315" | "H" | M8-1.25 | 12399 | 3* |
| 17537 | | | | | | | | 15 |
| 12387 | M6-1.0 | M10-1.25 | 2 | .394" | "S" | M10-1.25 | 12400 | 3* |
| 17538 | | | | | | | | 15 |
| 12389 | M8-1.0 | M12-1.25 | 4 | .472" | 27/64" | M12-1.25 | ◆ | 2* |
| 17539 | | | | | | | | 10 |
| 12390 | M8-1.25 | | | | | | | 2* |
| 17540 | | | | | | | | 10 |
| 12391 | M10-1.25 | M14-1.5 | 4 | .551" | 1/2" | M14-1.5 | ◆ | 2* |
| 17541 | | | | | | | | 10 |
| 12392 | M10-1.5 | | | | | | | 2* |
| 17542 | | | | | | | | 10 |

*Contains Economy Drive Tool 12404

† Not Packaged with the Thread Repair Inserts

◆ Professional tool not available. Can be set with 12404 Economy Drive Tool one kee at a time.

THREAD REPAIR INSERTS

Professional Insert Installation Tool



| Auveco Tool No. | Installs Insert Sizes (Internal Thread) |
|-----------------|---|
| 12394 | 1/4"-20 & 1/4"-28 |
| 12395 | 5/16"-18 & 5/16"-24 |
| 12396 | 3/8"-16 & 3/8"-24 |
| 12397 | 7/16"-14 & 7/16"-20 |

| Auveco Tool No. | Installs Insert Sizes (Internal Thread) |
|-----------------|---|
| 12399 | M5-0.8 |
| 12400 | M6-1.0 |
| 16163 | 5/8"-11 H.D. & 5/8"-18 H.D. |
| 16164 | 3/4"-10 H.D. & 3/4"-16 H.D. |

Economy Driver Tool



No. 12404

Will install approximately 10 Inserts. Use with Thinwall Inserts up to 1/2" and 10mm Internal Diameter and Heavy Duty Inserts up to 1/2" Internal Diameter

UNIT PACKAGE: 5

Thread Repair Insert Assortments

| No. 12405 "Assortment Kit" Contains | | | No. 12406 "Assortment Kit" Contains | | | No. 12407 "Assortment Kit" Contains | | |
|---|-----|--------------------|---|-----|--------------------|---|-----|-------------------|
| Auveco Part No. | Qty | Size | Auveco Part No. | Qty | Size | Auveco Part No. | Qty | Size |
| 12374 | 3 | 10-24 | 12375 | 3 | 10-32 | 12387 | 2 | M6-1.0 |
| 12376 | 3 | 1/4"-20 | 12377 | 3 | 1/4"-28 | 12389 | 2 | M8-1.0 |
| 12378 | 3 | 5/16"-18 | 12379 | 3 | 5/16"-24 | 12390 | 2 | M8-1.25 |
| 12380 | 3 | 3/8"-16 | 12381 | 3 | 3/8"-24 | 12391 | 2 | M10-1.25 |
| 12404 | 2 | Installation Tools | 12404 | 2 | Installation Tools | 12404 | 1 | Installation Tool |

Sec. 9

HELICAL THREAD REPAIR INSERTS & KITS

For Repairing Stripped Or Damaged Threads

The most effective and universally accepted method of thread repair.

Inserts quickly and permanently restores stripped, worn or damaged threads to their original size and condition.



Easy to use... just 1. Drill 2. Tap 3. Install
Now you're back to the original size and
the original size fastener can be used.



When threads become stripped, worn or damaged for any reason, the strength and reliability are greatly reduced. When this happens on critical threaded assemblies, cars, and other types of equipment, it may become unsafe to operate. These potentially dangerous situations are eliminated when the damaged thread is repaired with a thread repair insert. The threaded insert provides stronger, more reliable threads than the original tapped hole and at the same time eliminates the possibility of thread wear, seizing and corrosion.

| Thread Size & Length | Kits | | Insert | | Metal Installation Tool | | Tap | | Required Drill Size |
|--|---|-----------------|-----------------|-----------|-------------------------|-----------|-----------------|-----------|-------------------------------------|
| | Contents: Number of inserts shown, one installation tool & one tap. | | | | | | | | |
| | Auveco Kit No. | Inserts Per Kit | Auveco Part No. | Unit Pkg. | Auveco Part No. | Unit Pkg. | Auveco Part No. | Unit Pkg. | |
| U.S.S. COARSE THREAD (18-8 Stainless Steel) | | | | | | | | | |
| 10-24 x .285" | 18621 | 10 | 18544 | 10 | 18571 | 1 | 18596 | 1 | 13/64" |
| 1/4"-20 x .375" | 18622 | 10 | 18545 | 10 | 18572 | 1 | 18597 | 1 | 17/64" |
| 5/16"-18 x .469" | | | | | 18573 | 1 | 18598 | 1 | 21/64" |
| 3/8"-16 x .562" | 18624 | 10 | 18547 | 10 | 18574 | 1 | 18599 | 1 | 25/64" |
| 7/16"-14 x .656" | | | 18548 | 10 | 18575 | 1 | 18600 | 1 | 29/64" |
| 1/2"-13 x .750" | 18626 | 5 | 18549 | 10 | 18576 | 1 | 18601 | 1 | 17/32" |
| 5/8"-11 x .938" | 18627 | 5 | 18550 | 10 | 18577 | 1 | 18602 | 1 | 21/32" |
| 3/4"-10 x 1.125" | | | 18551 | 5 | 18578 | 1 | | | 25/32" |
| S.A.E. FINE THREAD (18-8 Stainless Steel) | | | | | | | | | |
| 10-32 x .285" | 18629 | 10 | 18552 | 10 | 18579 | 1 | 18604 | 1 | 13/64" |
| 1/4"-28 x .375" | 18630 | 10 | 18553 | 10 | 18580 | 1 | 18605 | 1 | 17/64" |
| 5/16"-24 x .469" | | | 18554 | 10 | 18581 | 1 | | | 21/64" |
| 3/8"-24 x .562" | | | 18555 | 10 | 18582 | 1 | 18607 | 1 | 25/64" |
| 7/16"-20 x .656" | | | | | 18583 | 1 | | | 29/64" |
| 1/2"-20 x .750" | 18634 | 5 | 18557 | 10 | 18584 | 1 | 18609 | 1 | 33/64" |
| METRIC REGULAR PITCH (18-8 Stainless Steel) | | | | | | | | | |
| M6-1.00 x 9.0mm | 18635 | 10 | 18558 | 10 | 18585 | 1 | 18610 | 1 | 1/4" |
| M8-1.25 x 12.0mm | 18636 | 10 | 18559 | 10 | 18586 | 1 | 18611 | 1 | 21/64" |
| M9-1.25 x 13.5mm | | | | 10 | 18587 | 1 | 18612 | 1 | "U" |
| M10-1.50 x 15.0mm | | | 18561 | 10 | 18588 | 1 | 18613 | 1 | 13/32" |
| M11-1.50 x 16.5mm | | | | | 18589 | 1 | 18614 | 1 | 29/64" |
| M12-1.75 x 18.9mm | 18644 | 5 | 18565 | 5 | 18592 | 1 | 18617 | 1 | 31/64" |
| METRIC FINE PITCH (18-8 Stainless Steel) | | | | | | | | | |
| M10-1.25 x 15.0mm | | | 18563 | 10 | 18590 | 1 | | | 13/32" |
| M11-1.25 x 16.5mm | | | 18564 | 10 | | | | | 29/64" |
| M12-1.50 x 18.0mm | | | 18566 | 5 | 18593 | 1 | 18618 | 1 | 31/64" |
| M12-1.25 x 18.0mm | 18642 | 5 | 18567 | 5 | 18594 | 1 | 18619 | 1 | 31/64" |
| SPARK PLUG THREAD (Mild Carbon Steel) | | | | | | | | | |
| M14-1.25 x 3/8" | | | 18568 | 2 | 18595 | 1 | 18620 | | Do Not Drill. Use Piloted Tap 18620 |
| M14-1.25 x 1/2" | | | 18569 | 2 | | | | | |
| M14-1.25 x 3/4" | | | 18570 | 2 | | | | | |

JACK NUTS®
Material - 1010 Steel - Zinc Plated

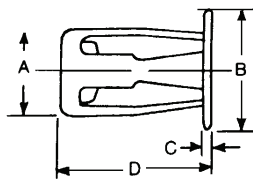

Type 1



Type 2



Type 3

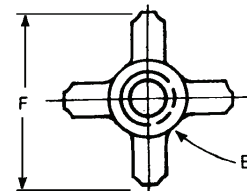

| Auveco Part No. | Unit Pkg. | Type | Thread (E) | Body Dia. (A) | Head Dia. (B) | Cap Thick (C) | Overall Lgth (D) | Grip Range | Required Hole Dia. | Maximum Spread (F)** |
|-----------------|-----------|------|------------|---------------|---------------|---------------|------------------|-------------|--------------------|----------------------|
| 13012 | 25 | 1 | 6-32 | .318 | .468 | .073 | .653 | 1/64"-3/16" | .315-.330 | .660 |
| 13014 | 25 | 1 | 10-24 | .382 | .531 | .073 | .716 | 1/64"-3/16" | .385-.400 | .760 |
| 13016 | 25 | 1 | 1/4"-20 | .438 | .625 | .073 | .731 | 1/64"-3/16" | .434-.450 | .890 |
| 16235* | 15 | 2 | 1/4"-20 | .438 | .625 | .073 | .731 | 1/64"-3/16" | .434-.450 | .890 |
| 13017 | 25 | 1 | 1/4"-20 | .438 | .625 | .073 | .919 | 3/16"-3/8" | .434-.450 | .890 |
| 16227 | 25 | 1 | M4-.7 | .318 | .468 | .073 | .841 | 3/16"-3/8" | .318-.330 | .720 |
| 16234• | 25 | 3 | M6-1.0 | .438 | .625 | .073 | .731 | 1/64"-3/16" | .438-.450 | .890 |

* Raintite Sealer

** Spread Varies With Material Thickness

• Sealer

See Jack Nut® Installation Tools On Next Page

Special Purpose Jack Nuts®

| Auveco Part No. | O.E.M. Number | Type | Thread | Finish | O.E.M. Application | Unit Pkg. |
|-----------------|-----------------------------|------|--------|-----------------|-------------------------------------|-----------|
| 12995 | GM: 367292 Chry: 6031438 | 3 | 1/4-20 | Zinc w/Sealer | GM Mirror Mounting Nut | 25 |
| 12996 | GM: 367292 Chry: 6031438 | 3 | 1/4-20 | Zinc w/ Sealer | GM Mirror Mounting Nut | 100 |
| 12998 | GM: 1623436 | 2 | M5-.8 | Zinc w/Raintite | GM "J" Body Rack Mount | 10 |
| 16230 | GM: 5970995 | 1 | M6-1.0 | Zinc | License Plate Mounting Bracket | 25 |
| 12997 | GM: 1635218, 10014363 | 1 | M6-1.0 | Zinc | GM License Plate Nut | 25 |
| 12999 | GM: 14007940 | 2 | M6-1.0 | Zinc w/Raintite | GM "X" & "Y" Roof Rack Mounting Nut | 10 |

Sec. 9

JACK NUT® INSTALLATION TOOLS

Tool comes with 16856 (6-32 Thread) Installation Rod



Part No. 14157
Professional Jacknut® Installation Tool

UNIT PACKAGE: 1

An economical tool for rapidly installing Jack Nuts in any material. Takes interchangeable screw rods. Just screw rod into Jack Nut, push into hole, squeeze to set and remove. Sets all size Jack Nut Threaded Inserts.

Jacknut® Installation Rods

Use w/14157 Installation Tool



| Auveco Part No. | Unit Pkg. | Thread |
|-----------------|-----------|--------|
| 16856 | 1 | 6-32 |
| 14158 | 1 | 10-24 |
| 14159 | 1 | 1/4-20 |
| 14160 | 1 | 4mm |
| 14161 | 1 | 5mm |
| 14162 | 1 | 6mm |

Part No. 14156
Friction Wrench



For use when installing a limited quantity of Jack Nuts. Insert the wrench between the screw and the head of the fastener, hold wrench and run in screw to set Jack Nut.

UNIT PACKAGE: 10



Mirror Mounting Screws And Jack Nuts

For additional information refer to listings on pages 21 and 52.

| Auveco Part No. | Description | Unit Pkg. |
|-----------------|---|-----------|
| 13231 | 1/4-20 x 7/8" Screw (Phos.) | 25 |
| 13232 | 1/4-20 x 7/8" Screw (Phos.) & Jack Nut® | 25 |
| 14947 | M6 x 26mm Screw (Chrome) | 25 |
| 14976 | 1/4-20 x 1-1/4" Screw (Stainless Steel) | 25 |
| 14977 | 1/4-20 x 1-1/4" Screw (Stainless Steel) & Jack Nut® | 10 |

RUBBER NUT INSERTS

Neoprene Rubber With A Brass Nut

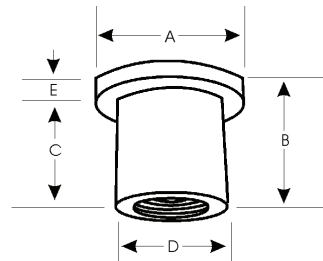

| Part Number | Unit Pkg. | Thread | (A) Head Dia. | (B) Overall Length | (C) Shank Length | (D) Shank Dia. | (E) Head Height | Hole Size | Grip Range |
|-------------|-----------|---------|---------------|--------------------|------------------|----------------|-----------------|-----------|------------|
| 19911 | 25 | #6-32 | .433 | .496 | .441 | .311 | .055 | 5/16 | .015-.156 |
| 19917 | 15 | 5/16-18 | .870 | .721 | .595 | .626 | .126 | 5/8 | .015-.156 |
| 19918 | 15 | M5-8 | .551 | 1.570 | 1.519 | .375 | .051 | 3/8 | .808-1.182 |

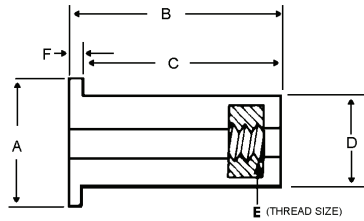

WELL NUTS®

Material - Neoprene with Captive Brass Nut



| Auveco Part No. | Unit Pkg. | (E) Thread | (A) Head Dia. | (B) Overall Length | (C) Shank Length | (D) Shank Dia. | (F) Head Thick | Hole Size | Grip Range (For Wall Thickness) | O.E.M. Number | O.E.M. Application |
|-----------------|-----------|----------------------------|---------------|--------------------|------------------|----------------|----------------|-----------|---------------------------------|---------------------------------|----------------------------|
| 13006 | 25 | #6-32 | .452 | .499 | .437 | .312 | .062 | 5/16 | .015-.156 | | |
| 16236 | 25 | #6-32 | .554 | .981 | .946 | .240 | .035 | 1/4 | .375-.607 | | |
| 16237 | 25 | #8-32 | .438 | .499 | .447 | .312 | .052 | 5/16 | .015-.156 | Chry: 6026166 GM: 347065 | Rear Compt. Cover Support |
| 13005 | 25 | #8-32 | .750 | .575 | .500 | .312 | .062 | 5/16 | .015-.172 | GM: 14048060 | License Plate |
| 16240 | 25 | #10-24 | .562 | .767 | .580 | .375 | .187 | 3/8 | .030-.227 | GM: 3876130 | Voltage Reg & Dome Light |
| 16246† | 25 | #10-32 | .510 | .400 | .341 | .375 | .059 | 3/8 | .015-.050 | GM: 6264396 AMC: 4005237 | Hatchback Window Brkt |
| 13007 | 25 | #10-32 | .500 | .554 | .518 | .377 | .036 | 3/8 | .015-.192 | | |
| 13009 | 10 | #10-32 | .562 | .665 | .625 | .377 | .040 | 3/8 | .035-.232 | GM: 12338025 | Luggage Rack |
| 17586 | 15 | #10-32 | .750 | .703 | .625 | .375 | .078 | 3/8 | .030-.227 | | |
| 16244 | 25 | #10-32 | .750 | .807 | .620 | .375 | .187 | 3/8 | .030-.227 | | |
| 13008 | 10 | #10-32 | .562 | 1.051 | 1.000 | .375 | .051 | 3/8 | .312-.643 | | |
| 13004 | 25 | 1/4-20 | .625 | .641 | .594 | .500 | .051 | 1/2" | .015-.111 | GM: 528846 AMC: 4003120 | Luggage Rack |
| 16255 | 15 | 1/4-20 | .635 | .801 | .750 | .500 | .051 | 1/2" | .187-.343 | | |
| 13010 | 10 | 1/4-20 | .740 | .829 | .642 | .500 | .187 | 1/2" | .031-.187 | | |
| 16253 | 25 | 1/4-20 | .635 | 1.051 | 1.000 | .500 | .051 | 1/2" | .250-.457 | GM: 342271 | Luggage Rack |
| 13011 | 10 | 5/16-18 | .875 | .725 | .600 | .620 | .125 | 5/8 | .015-.187 | | |
| 16242 | 25 | M5-8 | .500 | .554 | .518 | .375 | .036 | 3/8 | .015-.192 | | |
| 16248 | 25 | M5-8 | .562 | .665 | .625 | .375 | .040 | 3/8 | .035-.232 | GM: 14005097 | Service Part |
| 13000 | 10 | M6-1.0 w/ss screw #10 Head | .787 | .630 | .579 | .500 | .051 | 1/2" | .015-.094 | GM: 20130258, 14002811 | Station Wagon Roof Rack |
| 13001 | 50 | | | | | | | | | | |
| 13002 | 10 | | | | | | | | | | |
| 13003 | 50 | M6-1.0 | .787 | .630 | .579 | .500 | .051 | 1/2" | .015-.094 | GM: 20130258, 14002811 | Station Wagon Roof Rack |
| 16251 | 25 | M6-1.0 | .630 | .630 | .579 | .500 | .051 | 1/2" | .015-.111 | GM: 15505451 AMC: 8934201293 | Luggage Rack License Plate |
| 16252 | 25 | M6-1.0 | .750 | .829 | .642 | .500 | .187 | 1/2" | .031-.187 | VW: 175 820 435 | Luggage Rack |
| 16254 | 25 | M6-1.0 | .635 | 1.051 | 1.000 | .500 | .051 | 1/2" | .250-.457 | | |
| 16256 | 10 | M8-1.25 | .875 | .725 | .600 | .620 | .125 | 5/8 | .015-.156 | AMC: 8934201493 | Radiator Brkt. |

† Comes with snap-in feature

TUBULAR TYPE NUTS
(LISTED BY STUD SIZE)
ILLUSTRATIONS ACTUAL SIZE



Twice Actual Size
13962
 Amber Nylon
 5/64" Stud Size
 Barrel Length: 7/32"
 Head Dia.: 7/32"
 Head Thick: 3/64"
 Fits Into 5/32" Hole
 UNIT PACKAGE: 50



Twice Actual Size
3776
 Phosphate
 3/32" Stud Size
 Panel Range: .032"-.040"
 Fits Into 1/8" Hole
 UNIT PACKAGE: 100



Twice Actual Size
3137
 Phosphate
 3/32" Stud Size
 Panel Range: .025"-.175"
 Fits Into 1/8" Hole
 UNIT PACKAGE: 100



11293
 (375890-S102)
 Green
 With Sealer
 1/8" Stud Size
 Panel Range: .035"-.045"
 Fits Into 3/16" Hole
 UNIT PACKAGE: 50



13964
 Natural Nylon
 1/8" Stud Size
 Barrel Length: 11/32"
 Head Dia.: 15/64"
 Head Thick: 1/32"
 Fits Into 11/64" Hole
 UNIT PACKAGE: 50



2595
 Phosphate
 1/8" Stud Size
 Panel Range: .040"-.045"
 Fits Into 3/16" Hole
 UNIT PACKAGE: 100



3777
 Phosphate
 1/8" Stud Size
 Panel Range: .038"-.044"
 Fits Into 5/32" Hole
 UNIT PACKAGE: 100



2611
 Phosphate
 1/8" Stud Size
 Panel Range: .030"-.036"
 Fits Into 5/32" Hole
 UNIT PACKAGE: 100



5854
 (373528-S32)
 (6000605)
 Phosphate
 1/8" Stud Size
 Panel Range: .025"-.045"
 Fits Into 3/16" Hole
 UNIT PACKAGE: 100



5195
 (375480-S100)
 (3783794)
 Phosphate
 1/8" Stud Size
 Panel Range: .036"-.046"
 Fits Into 1/4" Hole
 UNIT PACKAGE: 100



13965
 (4006316)
 White Nylon
 5/32" Stud Size
 Barrel Length 1/4"
 Head Dia. 1/4"
 Head Thick. 1/32"
 Fits Into 3/16" Hole
 UNIT PACKAGE: 100



8545
 Phosphate
 5/32" Stud Size
 Panel Range: .062"-.068"
 Fits Into 7/32" Hole
 UNIT PACKAGE: 100



8546
 Phosphate
 5/32" Stud Size
 Panel Range: .049"-.055"
 Fits Into 7/32" Hole
 UNIT PACKAGE: 100



10073
 (6000558)
 Phosphate
 3/16" Stud Size
 Panel Range: .038"-.044"
 Fits Into 7/32" Hole
 UNIT PACKAGE: 100



2565
 Phosphate
 3/16" Stud Size
 Panel Range: .020"-.032"
 Fits Into 7/32" Hole
 UNIT PACKAGE: 100



13966
 (8934-201-767)
 Black Nylon
 3/16" Stud Size
 Barrel Length 17/64"
 Head Dia. 5/16"
 Head Thick. 1/32"
 Fits Into 17/64" Hole
 UNIT PACKAGE: 100



8578
 White Nylon
 #10 Thread Screw
 Fits Into 5/16" Hole
 UNIT PACKAGE: 50



5196
 (354341-S)
 Phosphate
 1/4" Stud Size
 Panel Range: .034"-.040"
 Fits Into 9/32" Hole
 UNIT PACKAGE: 100



19537
 (6000258)
 Phosphate
 1/4" Stud Size
 Panel Range: .030"-.034"
 Fits Into 5/16" Hole
 UNIT PACKAGE: 50

For An Assortment Of Tubular Nuts See Fix-Kits 6007 & 6502 in the green pages.

Flat Nuts
(ILLUSTRATIONS ACTUAL SIZE)

For Screws

 **1896**
Phosphate
#2-56 Machine Screw Size
7/32" x 3/8"
UNIT PACKAGE: 100

 **2089**
Phosphate
#6-32 Machine Screw Size
5/16" x 1/2"
UNIT PACKAGE: 100

 **1898**
Phosphate
#6-32 Machine Screw Size
1/2" x 7/8"
UNIT PACKAGE: 100

 **18209**
Phosphate
#8 Tapping Screw Size
5/16" x 1/2"
UNIT PACKAGE: 100

 **5563**
Phosphate
No. 8 Tapping Screw Size
13/32" x 5/8"
UNIT PACKAGE: 100

 **3793**
Phosphate
No. 8 Tapping Screw Size
13/32" x 5/8"
UNIT PACKAGE: 100

 **1899**
Phosphate
#8-32 Machine Screw Size
1/2" x 7/8"
UNIT PACKAGE: 100

 **2091**
Phosphate
#8-32 Machine Screw Size
5/16" x 1/2"
UNIT PACKAGE: 100

 **1900**
Phosphate
#10 Tapping Screw
Size 1/2" x 7/8"
UNIT PACKAGE: 100

 **2092**
Phosphate
#10-24 Machine
Screw Size
7/16" x 3/4"
UNIT PACKAGE: 100

 **1912**
Phosphate
#12 Tapping Screw Size
1/2" x 3/4"
UNIT PACKAGE: 100

 **1903**
Phosphate
1/4"-20 Machine Screw Size
9/16" x 1"
UNIT PACKAGE: 100

For Studs

 **2098**
Phosphate
1/16" Stud Size
7/32" x 3/8"
UNIT PACKAGE: 100

 **2100**
Phosphate
3/32" Stud Size
1/4" x 7/16"
UNIT PACKAGE: 100

 **1906**
Phosphate
.100" or 3/32" Stud Size
7/32" x 7/16"
UNIT PACKAGE: 100

 **2099**
Phosphate
1/8" Stud Size
5/16" x 9/16"
UNIT PACKAGE: 100

 **2102**
Phosphate
5/32" Stud Size
3/8" x 9/16"
UNIT PACKAGE: 100

 **1905**
Phosphate
5/32" Stud Size
7/16" x 3/4"
UNIT PACKAGE: 100

 **2426**
Phosphate
3/16" Stud Size
3/8" x 5/8"
UNIT PACKAGE: 100

 **2103**
Phosphate
3/16" Stud Size
3/8" x 5/8"
UNIT PACKAGE: 100

 **2105**
Phosphate
1/4" Stud Size
7/16" x 5/8"
UNIT PACKAGE: 100

 **3138**
Phosphate
5/16" Stud Size
1/2" x 11/16"
UNIT PACKAGE: 100

 **3139**
Phosphate
3/8" Stud Size
9/16" x 3/4"
UNIT PACKAGE: 100

Sec. 9**“U” & “J” Type Nuts By Screw Size**

(ILLUSTRATIONS ACTUAL SIZE)

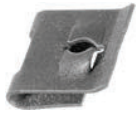
**9625**
Phosphate#6 Screw Size
Panel Range: .090" - .110"
Ctr Of Hole To Edge: 9/32"

UNIT PACKAGE: 100

**21007**
Phosphate#6-32 Screw Size
Panel Range: .045" - .062"
Center of Hole To Edge: 5/16"

UNIT PACKAGE: 50

**5571**
Phosphate#8 Screw Size
Panel Range: .025"-.040"
Ctr Of Hole To Edge: 1/4"

UNIT PACKAGE: 100

**5836**
Phosphate#8 Screw Size
Panel Range: .025"-.035"
Ctr Of Hole To Edge: 3/8"

UNIT PACKAGE: 100

**2346**
Phosphate#8 Screw Size
Panel Range: .025"-.040"
Ctr Of Hole To Edge: 9/32"

UNIT PACKAGE: 100

**3796**
(9428481)
Phosphate#8 Screw Size
Panel Range: .025"-.040"
Center Of Hole To Edge: 1/4"

UNIT PACKAGE: 100

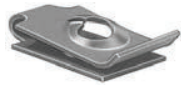
**10666**
Phosphate#8 Screw Size
Panel Range: .025"-.035"
Ctr Of Hole To Edge: 11/32"

UNIT PACKAGE: 100

**11292**
(445429,
9422552)
Phosphate#8 Screw Size
Panel Range: .045"-.062"
Center Of Hole To Edge: 3/8"

UNIT PACKAGE: 50

**11768**
(388248-S-36B)
Phosphate#8 Screw Size
Panel Range: .075"-.090"
Ctr Of Hole To Edge: 9/32"

UNIT PACKAGE: 50

**3778**
Phosphate#8 Screw Size
Panel Range: .035"-.051"
Center Of Hole To Edge: 5/16"

UNIT PACKAGE: 100

**19826**
(382163-S)
Phosphate#8 Screw Size
Panel Range: .145"-.160"
Center Of Hole To Edge: 9/32"
Replaces Auveco 11063

UNIT PACKAGE: 50

**8337**
Phosphate#8-18 Screw Size
Panel Range: .025"-.040"
Center Of Hole To Edge: 3/8"

UNIT PACKAGE: 50

**14822**
(25527289)
PhosphateM4.2-1.41 (#8) Screw Size
Panel Range: .094"-.109"
Center Of Hole To Edge: 7/32"

UNIT PACKAGE: 50

**14814**
(N803183-S32)
PhosphateM4.2-1.41 (#8) Screw Size
Panel Range: .094"-.156"
Center Of Hole To Edge: 1/2"

UNIT PACKAGE: 25

**18208**
Phosphate#10 Screw Size
Panel Range: .015"-.085"
Center Of Hole To Edge: 11/32"

UNIT PACKAGE: 100

**11429**
Phosphate#10 Screw Size
Panel Range: .015"-.060"
Center Of Hole To Edge: 15/32"

UNIT PACKAGE: 50

For an assortment of “U” & “J” Nuts, see Fix-Kits 6007 & 6502 in the green pages.

“U” & “J” Type Nuts By Screw Size

(ILLUSTRATIONS ACTUAL SIZE)

| | | |
|---|---|--|
|  <p>2303 Phosphate</p> <p>#10 Screw Size Panel Range: .027"-.045" Center Of Hole To Edge: 3/16"</p> <p>UNIT PACKAGE: 100</p> |  <p>5576 Phosphate</p> <p>#10 Screw Size Panel Range: .045"-.062" Center Of Hole To Edge: 13/32"</p> <p>UNIT PACKAGE: 100</p> |  <p>2420 Phosphate</p> <p>#14 Screw Size Panel Range: .028"-.056" Center Of Hole To Edge: 15/32"</p> <p>UNIT PACKAGE: 100</p> |
|  <p>3797 Phosphate</p> <p>#10 Screw Size Panel Range: .045"-.062" Center Of Hole To Edge: 13/32"</p> <p>UNIT PACKAGE: 100</p> |  <p>8341 Phosphate</p> <p>#10 Screw Size Panel Range: .025"-.060" Center Of Hole To Edge: 11/32"</p> <p>UNIT PACKAGE: 100</p> |  <p>2293 (9431647) Phosphate</p> <p>1/4"-20 Machine Screw Size Panel Range: .064"-.125" Center Of Hole To Edge: 9/16"</p> <p>UNIT PACKAGE: 100</p> |
|  <p>1913 Phosphate</p> <p>#10 Screw Size Panel Range: .020"-.051" Center Of Hole To Edge: 15/32"</p> <p>UNIT PACKAGE: 50</p> |  <p>5197 Phosphate</p> <p>#10-24 Machine Screw Size Panel Range: .045"-.062" Center Of Hole To Edge: 9/16"</p> <p>UNIT PACKAGE: 100</p> |  <p>1907 Phosphate</p> <p>5/16"-10 Tapping Screw Size Panel Range: .032"-.064" Center Of Hole To Edge: 1/2"</p> <p>UNIT PACKAGE: 50</p> |
|  <p>3770 Phosphate</p> <p>#10 Screw Size Panel Range: .030"-.037" Center Of Hole To Edge: 3/8"</p> <p>UNIT PACKAGE: 100</p> |  <p>1910 Phosphate</p> <p>#12 Screw Size Panel Range: .037"-.051" Center Of Hole To Edge: 1/2"</p> <p>UNIT PACKAGE: 50</p> | <p>For the most up-to-date information on new items available from Auveco, refer to the "Hot New Items" section of the Auveco website (www.auveco.com)</p> |
|  <p>2422 Phosphate</p> <p>#10 Screw Size Panel Range: .025"-.064" Center Of Hole To Edge: 3/8"</p> <p>UNIT PACKAGE: 100</p> |  <p>2057 Phosphate</p> <p>#14 Screw Size Panel Range: .032"-.040" Center Of Hole To Edge: 1/2"</p> <p>UNIT PACKAGE: 100</p> | |

Sec. 9**SPRING TYPE "U" NUTS****10064**
Phosphate#6 Screw Size
Panel Range: .025"-.125"
Center Of Hole To Edge: 3/8"

UNIT PACKAGE: 50

**10065**
Phosphate#8 Screw Size
Panel Range: .025"-.125"
Center Of Hole To Edge: 3/8"

UNIT PACKAGE: 25

16267Same As 10065 Except For Unit
Package Quantity

UNIT PACKAGE: 100

**9880**
(9424837, 9431530;
381818-S2)
Phosphate#8 Screw Size
Panel Range: .025"-.150"
Center Of Hole To Edge: 3/8"
GM, Ford

UNIT PACKAGE: 100

**9879**
(9440178, 11504531; 381863-S2)
Phosphate#8 Screw Size
Panel Range: .025"-.150"
Center Of Hole To Edge: 5/8"
GM, Ford

UNIT PACKAGE: 100

**20582**
(9433156)
Phosphate#8 Screw Size
Panel Range: .125" - .250"
Center Of Hole To Edge: 3/8"
GM

UNIT PACKAGE: 100

**10066**
Phosphate#10 Screw Size
Panel Range: .025"-.125"
Center Of Hole To Edge: 11/32"

UNIT PACKAGE: 25

**15752**
Phosphate#10 Screw Size
Panel Range: .025"-.150"
Center Of Hole To Edge: 9/16"

UNIT PACKAGE: 50

**9881**
(9425491)
Phosphate#14 Screw Size
Panel Range: .025"-.150"
Center Of Hole To Edge: 5/16"
GM

UNIT PACKAGE: 100

**10067**
Phosphate#14 Screw Size
Panel Range: .025"-.125"
Center Of Hole To Edge: 3/8"

UNIT PACKAGE: 25

**You Can E-Mail
Your New Item
Suggestions To
mail@auveco.com****"U" TYPE SPECIAL NUTS****14526**
(N802538-S100)
Green Phosphate#8 Screw Size
Panel Range: 1/16"-5/32"
Center Of Hole To Edge: 5/16"
17/32" Wide, 51/64" Long
Ford

UNIT PACKAGE: 50

**14527**
(10041588, 25530441)
Phosphate#8 Screw Size
Panel Range: 1/16"-3/16"
Center Of Hole To Edge: 19/32"
35/64" Wide, 1-1/32" Long
GM

UNIT PACKAGE: 50

**14750**
(Toyota: 53879-14010-A, 53879-14020,
53879-22030; GM: 94841226;
Mazda: LA01-56-135)Nylon "U" Nut Fender/Wheel
Housing Applications#10 Screw Size
20mm Wide
31mm LongPanel Range: Up to 1mm
Center of Hole To Edge: 11mm
Toyota, Geo Prizm & Nova
And Mazda

UNIT PACKAGE: 15

19669

Same As 14750 Except For Packing

UNIT PACKAGE: 25

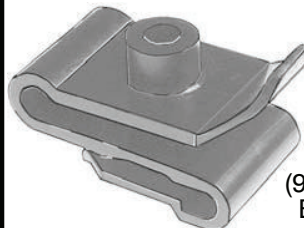
**20956**
(90467-05114)
Black NylonBumper & Fender Apron
Nylon "U" Nut
Screw Size: M5.5 (#12)
Width: 20mm, Length: 36mm
Center Of Hole to Edge: 14mm
Panel Range: Up To 1mm
Lexus & Toyota

UNIT PACKAGE: 10

“U” TYPE SPECIAL NUTS



19809

(650870AA)
Natural Nylon

#8 (M4.2) Screw Size
Panel Range: 1mm-4.25mm
Center Of Hole To Edge: 10mm
Chrysler

UNIT PACKAGE: 25

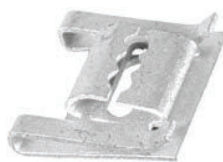

19163

Zinc

M4.2 (#8) Screw Size
3 Position “U” Nut
Panel Range: Up To 3/32"
Center Of Hole To Edge: 15/32"
27/32" Wide, 7/8" Long

UNIT PACKAGE: 25



19165

Phosphate

M4.2(#8) Screw Size
Multi-Position “U” Nut
Panel Range: Up To 5/64"
Center of Hole to Edge: 25/64"
3/4" Wide, 11/16" Long

UNIT PACKAGE: 25



19166

(1260888,
25556911)
Phos. & Blue

M4.2 (#8) Screw Size
Multi-Position “U” Nut
Panel Range: 1/16"-5/64"
Center Of Hole To Edge: 7/16"
Windshield Defroster Nozzle &
Various Instrument Panel
Applications
GM 1984-On

UNIT PACKAGE: 25



19162

(1638575,
25512688)
Zinc

M4.2 (#8) Screw Size
Panel Range: .035"-.049"
Center Of Hole To Edge: 9/16"
GM

UNIT PACKAGE: 25



19164

Phosphate

M4.2 (#8) Screw Size
4 Position “U” Nut
Panel Range: Up To 5/32"
Center Of Hole To Edge: 7/16"
15/16" Wide, 29/32" Long

UNIT PACKAGE: 25



10401

(545920, 9837022)
Phosphate

#8 Screw Size
Panel Range: 3/16"
Center Of Hole To Edge: 9/32"
Headlight Bezel To Grille “U” Nut
Front Side Marker, Radio/Tape
Player & Various Instrument Panel
Applications
GM 1977-On

UNIT PACKAGE: 50



“J” Type Cage Nuts
Phosphate Finish

| Center Auveco Part No. | Screw Size | Panel Range | Of Hole To Edge | Unit Pkg. |
|------------------------------|---------------|----------------|--------------------|--------------|
| 5586 | 1/4"-20 USS | .032/.093" | 1/2" | 50 |
| 3616 | 5/16"-18 USS | .087-.093" | 9/16" | 25 |
| 5589 | 5/16"-18 USS | .087-.093" | 9/16" | 50 |
| 5170 | 3/8"-16 USS | .050/.090" | 9/16" | 25 |

Sec. 9**EXTRUDED "U" NUTS**

(Foldover Nuts)

**10048**(45262)
Phosphate#8-32 Screw Size
Panel Range: .025"-.150"
Center Of Hole To Edge: 3/8"
Ford

UNIT PACKAGE: 50

**10050**(45263-S2)
Phosphate1/4"-20 Screw Size
Panel Range: .025"-.150"
Center Of Hole To Edge: 17/32"
Ford

UNIT PACKAGE: 25

**12265**(45264-S2)
Phosphate5/16"-18 Screw Size
Panel Range: .040"-.125"
Center Of Hole To Edge: 9/16"
Ford

UNIT PACKAGE: 50

**18898**(45262)
Phosphate#8-32 Screw Size
Panel Range: .079"-.118"
Center Of Hole To Edge: 3/8"
Ford

UNIT PACKAGE: 50

**10051**(45267; 1494257)
Phosphate1/4"-20 Screw Size
Panel Range: .025"-.150"
Center Of Hole To Edge: 25/32"
Ford, GM

UNIT PACKAGE: 50

**8377**(1480909)
Phosphate5/16"-18 Screw Size
Panel Range: .060"-.090"
Center Of Hole To Edge: 9/16"
GM

UNIT PACKAGE: 50

**15677**(152273)
Phosphate#10-24 Screw Size
Panel Range: .025"-.125"
Center Of Hole To Edge: 15/32"
GM

UNIT PACKAGE: 50

**8375**(152266)
Phosphate5/16"-18 Screw Size
Panel Range: .025"-.060"
Center Of Hole To Edge: 9/16"
GM

UNIT PACKAGE: 50

**8372**(152267)
Phosphate5/16"-18 Screw Size
Panel Range: .120"-.150"
Center Of Hole To Edge: 9/16"
GM

UNIT PACKAGE: 50

**8359**(1480627, 1494252)
Phosphate1/4"-20 Screw Size
Panel Range: .025"-.150"
Center Of Hole To Edge: 17/32"
GM

UNIT PACKAGE: 50

**10053**(Chry: 6023171; Ford: 45264)
Phosphate5/16"-18 Screw Size
Panel Range: .025"-.150"
Center Of Hole To Edge: 9/16"
Ford

UNIT PACKAGE: 50

**10830**(1494253)
Phosphate5/16"-18 Screw Size
Panel Range: .025"-.150"
Center Of Hole To Edge: 5/8"
GM

UNIT PACKAGE: 50

EXTRUDED "U" NUTS (Foldover Nuts)



8814
(1494258;
379831-S)
Phosphate

5/16"-18 Screw Size
Panel Range: .025"-.150"
Center Of Hole To Edge: 27/32"
GM, Ford

UNIT PACKAGE: 25



10052
(10008002;
45268-S2)
Phosphate

5/16"-18 Screw Size
Panel Range: .025"-.150"
Center Of Hole To Edge: 7/8"
GM, Ford

UNIT PACKAGE: 25



10054
(1494254, 12337873,
45265-S2)
Phosphate

3/8"-16 Screw Size
Panel Range: .050"-.200"
Center Of Hole To Edge: 3/4"
GM, Ford

UNIT PACKAGE: 25



10055
(45269)
Phosphate

3/8"-16 Screw Size
Panel Range: .050"-.200"
Center Of Hole To Edge: 1-1/8"
Ford

UNIT PACKAGE: 25

Metric Extruded "U" Nuts



18337
(GM: 11500654;
Ford: N623330-S2)
Zinc Organic

M4-.7 Screw Size
Panel Range: .60mm-3.8mm
(.030"-.150")
Center of Hole to Edge:
9.5mm (3/8")
GM, Ford

UNIT PACKAGE: 50



11625
(11500655)
Phosphate

M4-.7 Screw Size
Panel Range: .80mm-4.00mm
(.030"-.160")
Center Of Hole To Edge:
13.5mm (17/32")
GM

UNIT PACKAGE: 50



20339
(11516397)
Zinc Organic

M4.2-1.41 (#8) Screw Size
Locking Thread
Panel Range: .5mm-2.0mm
(.020"-.079")
Ctr of Hole to Edge: 10mm (25/64")
GM

UNIT PACKAGE: 50



21040
(11513599)
Zinc Organic

M4.2-1.41 (#8) Screw Size
Locking Thread
Panel Range: .65mm-3.8mm
(.025"-.150")
Ctr. Of Hole To Edge: 9.5mm (3/8")
GM

UNIT PACKAGE: 25



18338
(GM: 11505596;
Ford: N623331-S2)
Phosphate

M5-.8 Screw Size
Panel Range: .60mm-3.8mm
(.030"-.150")
Ctr Of Hole To Edge: 11mm (7/16")
GM, Ford

UNIT PACKAGE: 50



11626
(11500657)
Phosphate

M5-.8 Screw Size
Panel Range: .80mm-4.00mm
(.030"-.160")
Ctr Of Hole To Edge: 15.8mm (5/8")
GM

UNIT PACKAGE: 50



21539
(GM: 9114472)
Blue Nylon

M5.5 (#12) Screw Size
Panel Range: Up To 3.5mm (.138")
Center Of Hole To Edge:
8mm (5/16")
Use With Auveco 21541
GM

UNIT PACKAGE: 25

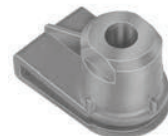

21540
(GM: 24449408)
Orange Nylon

M5.5 (#12) Screw Size
Panel Range: Up To 2mm (.079")
Center Of Hole To Edge:
12mm (15/32")
Use With Auveco 21541
GM & Saab

UNIT PACKAGE: 25

Sec. 9**EXTRUDED "U" NUTS**

(Foldover Nuts)

**16846**(6502152)
PhosphateM6-1.0 Screw Size
Tri-Lobular Locking Thread
Panel Range: .80mm-4.00mm
(.030"-.160")
Ctr Of Hole To Edge:
12mm (15/32")
Chrysler

UNIT PACKAGE: 50

**12669**1016937, 11503957;
N623332-S2,
-S53 & -S100
PhosphateM6-1.0 Screw Size
Panel Range: .80mm-4.00mm
(.030"-.160")
Center Of Hole To Edge:
13.5mm (17/32")
GM, Ford

UNIT PACKAGE: 25

**19144**(11505048)
Black PhosphateM6-1.0 Screw Size
Panel Range: 3.4mm-6.3mm
(.134"-.250")
Center Of Hole To Edge:
19mm (3/4")
GM Saturn

UNIT PACKAGE: 15

**16842**(11504047;
N802331-S53)
PhosphateM6-1.0 Screw Size
Panel Range: 3.4mm-6.3mm
(.140"-.250")
Center Of Hole To Edge:
13.5mm (17/32")
GM & Ford

UNIT PACKAGE: 25

**18881**(21095560)
Zinc
Cobalt BlackM6-1.0 Screw Size
Panel Range: 3.5mm-4.0mm
(.140"-.160")Ctr of Hole to Edge: 13.5mm (17/32")
GM Saturn 1991-On

UNIT PACKAGE: 10

**12575**(11503715,
11508241,
11609385)
PhosphateM6-1.0 Screw Size
Panel Range: .80mm-4.00mm
(.030"-.160")
Ctr of Hole to Edge:
19.5mm (25/32")
GM

UNIT PACKAGE: 25

**18449**(Chrys: 6101308;
Ford: N800854-S2)
PhosphateM6-1.0 Screw Size
Locking Thread
Panel Range: .80mm-4.00mm
(.030"-.160")
Center Of Hole To Edge:
13.5mm (17/32")
Chrysler

UNIT PACKAGE: 50

**12666**(11504978)
Zinc OrganicM6-1.0 Screw Size
Panel Range: 3.4mm-6.3mm
(.135"-.250")Ctr of Hole to Edge: 14.5mm (9/16")
GM

UNIT PACKAGE: 25

**16322**(14040999)
PhosphateM6-1.0 Screw Size
Panel Range: 1.0mm-2.5mm
(.045"-.095")
Ctr of Hole to Edge:
19.5mm (25/32")
GM

UNIT PACKAGE: 50

**11864**(11503714,
11503716)
PhosphateM6-1.0 Screw Size
Panel Range: .80mm-4.00mm
(.030"-.160")
Center Of Hole To Edge:
13.5mm (17/32")
GM

UNIT PACKAGE: 50

**20416**(11516372)
Zinc OrganicM6-1.0 Screw Size
Panel Range: 2.0mm-5.0mm
(.079" - .197")Center Of Hole To Edge:
14.5mm (9/16")
GM

UNIT PACKAGE: 25

**19480**(N805889-S100)
PhosphateM6-1.0 Screw Size
Panel Range: 4.3mm-5.6mm
(.172"-.219")
Center Of Hole To Edge:
21mm (13/16")
Ford

UNIT PACKAGE: 15

EXTRUDED "U" NUTS

Sec. 9

(Foldover Nuts)



11627

(11502785,
11504035)
Phosphate

M6.3-1.0 Screw Size
Panel Range: .80mm-4.00mm
(.030"-.160")
Ctr of Hole to Edge: 13.5mm (17/32")
GM

UNIT PACKAGE: 25



11629

(11500660, 11502617;
N623333-S2; 6101283)
Phosphate

M8-1.25 Screw Size
Panel Range: .80mm-4.00mm
(.030"-.160")
Cntr of Hole to Edge: 14.5mm (9/16")
GM, Ford, Chrysler

UNIT PACKAGE: 25



18401

(N801117-S100)
Black Phosphate

M8-1.25 Screw Size
Locking Thread
Panel Range: 4mm-7mm
(.157"-.276")
Center of Hole to Edge:
21mm (13/16")
Ford

UNIT PACKAGE: 25



11628

(9433043,
11500658)
Phosphate

M6.3-1.0 Screw Size
Panel Range: .80mm-4.00mm
(.030"-.160")
Ctr of Hole to Edge: 13.5mm (17/32")
GM

UNIT PACKAGE: 25



11630

(11500661, 11503317, 11516150;
N623343-S2 & S100)
Phosphate

M8-1.25 Screw Size
Panel Range: .80mm-4.50mm
(.030"-.170")
Ctr of Hole to Edge: 20mm (13/16")
GM, Ford

UNIT PACKAGE: 25



11631

(11500662, 22531616)
Phosphate

M10-1.50 Screw Size
Panel Range: 1.0mm-6.0mm
(.040"-.230")
Center of Hole to Edge: 19mm (3/4")
GM

UNIT PACKAGE: 25



12667

(11503455,
11504288)
Zinc Organic

M8-1.25 Screw Size
Panel Range: 1.50mm-5.50mm
(.060"-.216")
Cntr of Hole to Edge: 14.5mm (9/16")
GM

UNIT PACKAGE: 25



19644

(10084751)
Phosphate

M8-1.25 Screw Size
Panel Range: 1.7mm-5.5mm
(.067"-.217")
Ctr Of Hole To Edge:
28.5mm (1-1/8")
GM

UNIT PACKAGE: 15



18339

(GM: 11500663; Ford: N623344-S2)
Zinc Organic

M10-1.5 Screw Size
Panel Range: 1.5mm-5.5mm
(.060"-.215")
Ctr of Hole to Edge: 28mm (1-3/32")
GM, Ford

UNIT PACKAGE: 25